

Tool- catalog

Edition 2018

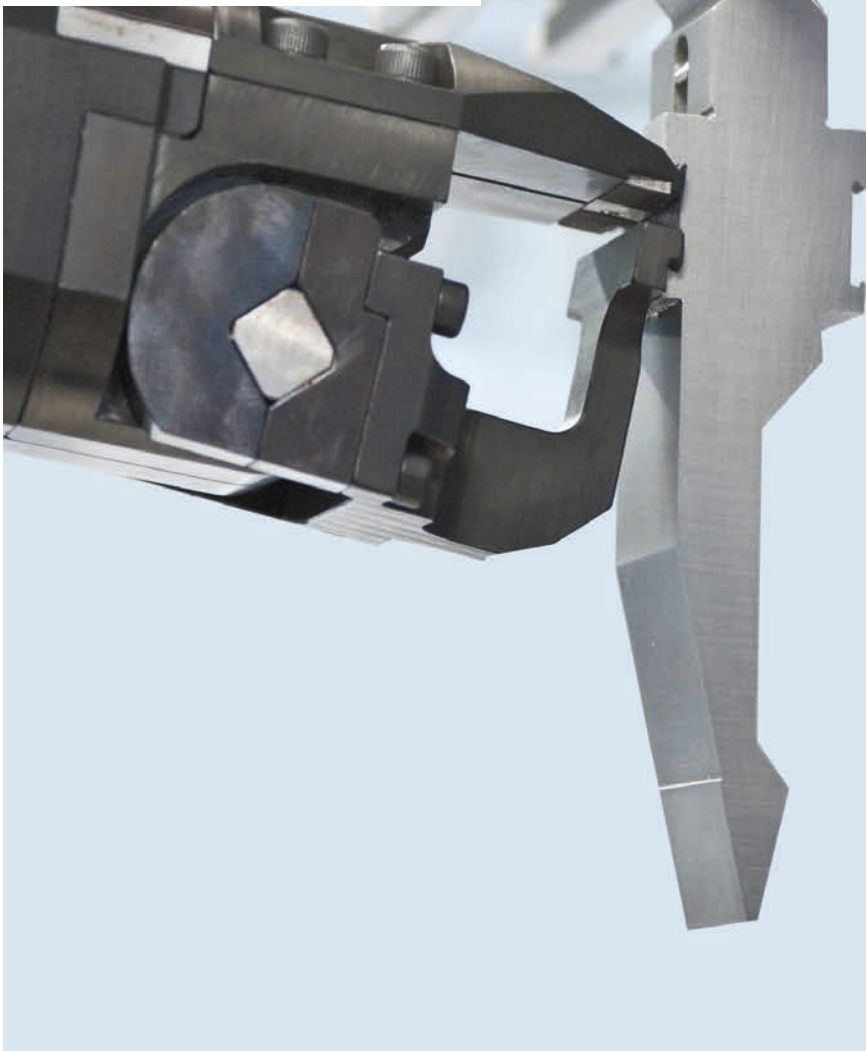

TRUMPF LASERdur Bending Tools
TruBend Cell 7000

Machine Tools / Power Tools
Laser Technology / Electronics

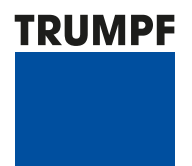



Tool catalog

TRUMPF LASERdur Bending Tools TruBend Cell 7000

Edition: **3/2018**

Mat.No. **1866343 TAT**

This document was compiled by the technical documentation department of TRUMPF Maschinen Austria GesmbH & Co. KG.

All rights to this documentation, especially the rights of reproduction and distribution as well as that of translation are reserved by TRUMPF Maschinen Austria GesmbH & Co. KG, even in the case of notifications of protective privilege. No part of this documentation may be reproduced, processed, duplicated or distributed by means of electronic systems in any form whatsoever without the prior written consent of TRUMPF Maschinen Austria GesmbH & Co. KG. Errors excepted; subject to technical modifications.

© TRUMPF Maschinen Austria GesmbH & Co. KG

TRUMPF Maschinen Austria GesmbH & Co. KG cannot be made responsible for possible mistakes in this documentation. No liability is accepted for direct or indirect damage or injury resulting from the delivery or use of this documentation, in so far as this is legally permissible.

*The **prices** are to be understood as being **exclusive of VAT**.*

Before you read on...

Regarding the content Here you can find interesting facts, technical information and prices for >A< bending tools.

Supplementary information E-shop for bending tools, go to www.TRUMPF.com/myTRUMPF



If you have any further questions ask your TRUMPF sales partner See Addresses at the end of the document

Table of contents

General	Bending tools for automation.....	8
	Additional charges for the modification of standard tools.....	11
	Extra charges for LASERdur ZN coating.....	12
	Explanation of symbols.....	15
Punches	>A< OW200/S.....	16
	>A< OW201/S.....	16
	>A< OW202/S.....	17
	>A< OW203/S.....	17
	>A< OW204/S.....	18
	>A< OW280/S.....	18
	>A< OW282/S.....	19
Sensor tools	>A< OW211/S.....	20
	ACB >A< OW202/S.....	21
	ACB >A< OW203/S.....	22
	ACB >A< OW201/S.....	23
	ACB >A< OW200/S.....	24
Folding	ACB >A< OW280/S.....	25
	ACB >A< OW282/S.....	26
	>A< OW215/S.....	27
	>A< EV-F W6,2.....	27
Dies	>A< EV-F W8.....	28
	>A< EV-F W10.....	28
	4 mm die width.....	29
	5 mm die width.....	30
	6 mm die width.....	32
	8 mm die width.....	34
	10 mm die width.....	36
	12 mm die width.....	38
	16 mm die width.....	40
	20 mm die width.....	42
	24 mm die width.....	43
	30 mm die width.....	44
	40 mm die width.....	45
50 mm die width.....	46	
RollBend.....	47	
>A< RB 200.....	47	
>A< RB 300.....	47	
>A< RB 400.....	48	
Z bending	>A< OWZ/S 90° Z4.....	49
	>A< EVZ 90° Z4.....	49
	>A< OWZ/S 90° Z6.....	50
	>A< EVZ 90° Z6.....	50
	>A< OWZ/S 90° Z8.....	51
	>A< EVZ 90° Z8.....	51
	>A< OWZ/S 90° Z10.....	52
>A< EVZ 90° Z10.....	52	
Accessories	Adapter.....	53
	Upper tools.....	54
	Lower tools.....	55
	ACB Sensor tools.....	56
Technical Section	ACB initial equipment TruBend Cell 7000.....	58
	System division of >A< bending tools.....	59
	Technical details.....	60
	Tool variants.....	61

The TRUMPF system

TruBend Cell 7000

TruBend Cell 7000:
The advantages for you at a glance.

- 1 Minimal cost per tilt
- 2 Low tooling time
- 3 Optimized material flow
- 4 Comfortable offline programming
- 5 Compact entire system

Innovative high speed bending cell.

The TruBend Cell 7000 is the world's fastest system for automatic small part bending. This is ensured by back-gauges of a light construction and a particularly dynamic drive concept.

You significantly reduce your part costs thanks to the extremely high bending productivity.

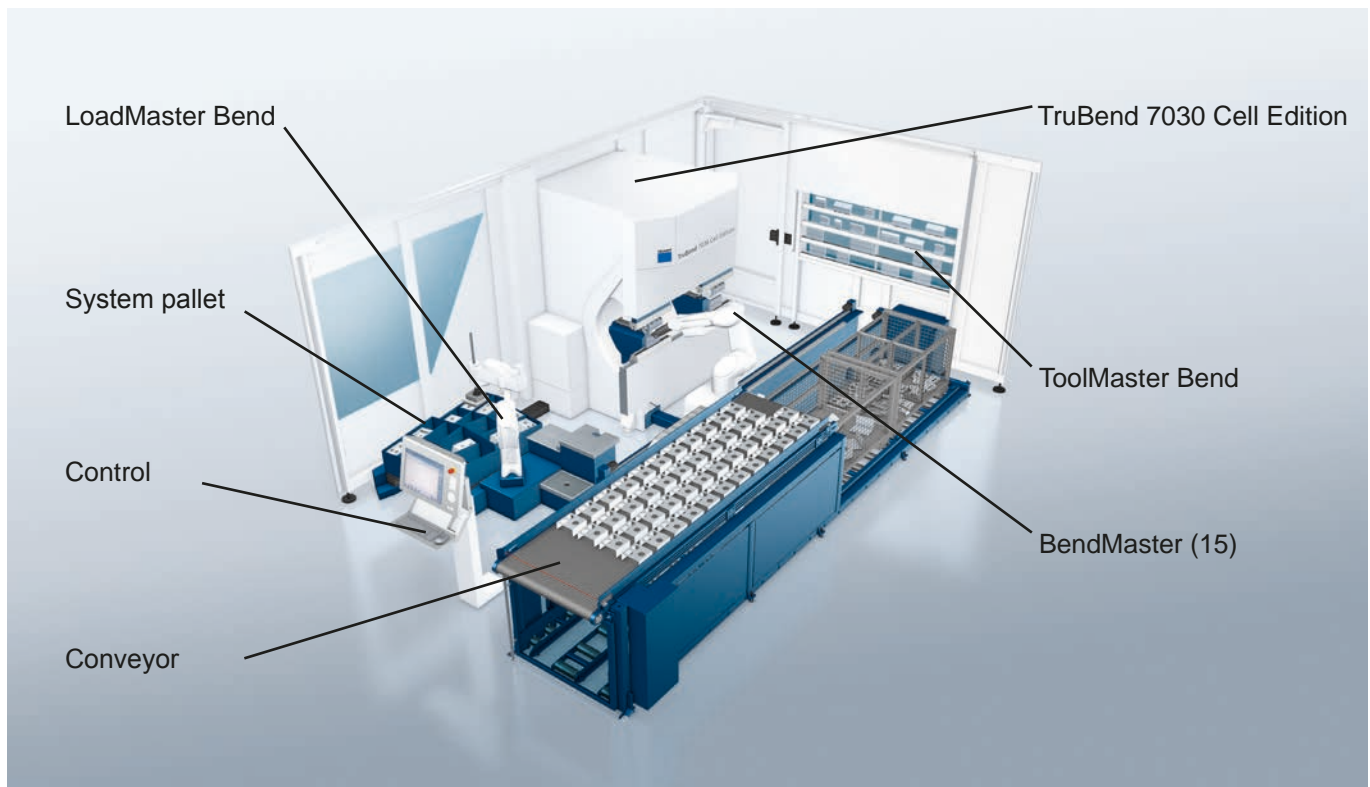



BendMaster (15)

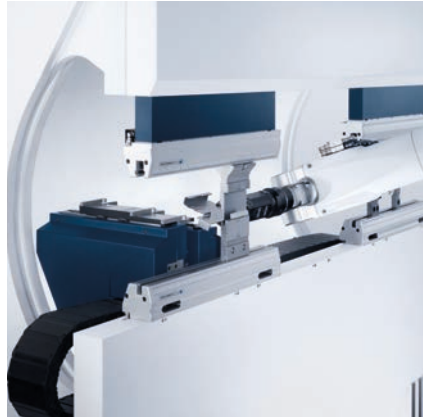

Shared tool clamp for optimal gripper use



ToolMaster Bend

Maximum productivity.

- Doubled part throughput compared to traditional bending cells
- TruBend 7036 Cell Edition as a dynamic bending unit with a press force of 36 t
- Highly dynamic due to the electrical torque motor for accelerating the press beam
- Flying backgauges with a lightweight construction for fast positioning of parts
- Innovative press beam divided into 2 x 510 mm creates clearance for gripper use

Effortless tool change.

The ToolMaster Bend automatically sets up the correct tools – without any gripper change.

The sensor system detects the tool type and its position. This also means that you can arrange the bending tools any way that suits you in ToolMaster Bend. Particularly in the case of small lot sizes, you benefit from ToolMaster Bend: your machine processes different orders without the involvement of personnel.



Features of >A< tools

>A< tools (automation) differ significantly from manual tools. This is a completely new type of tool system.

TIS (ID chip) provides the intelligence which is responsible for the entire procedure of a tool change. Each individual tool type is detected in its current position, wherever it is at the time (in the machine or in the tool magazine). TIS is also used for position and tool type recognition.

A highly precise **exchange groove** and a **special click** on the tool head guarantee a safe tool change.

The **shoulder-bearing design** ensures a highly precise position of the tools in the machine.

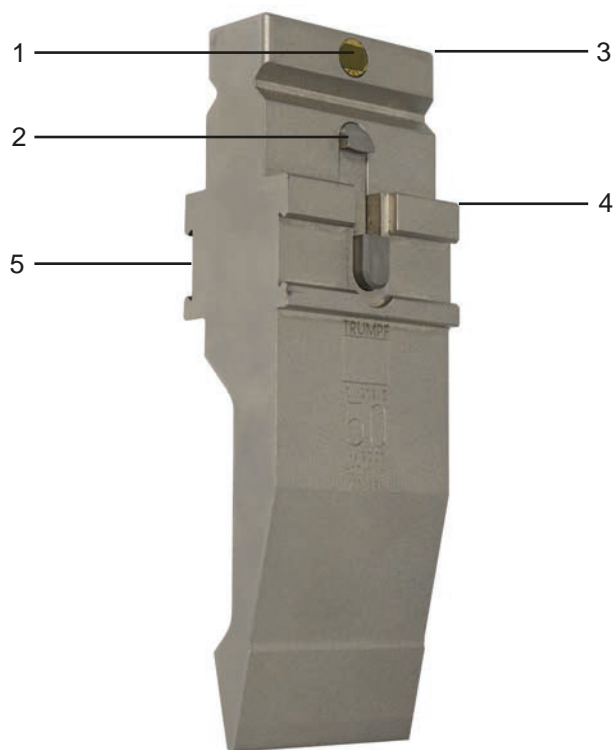

- 1 ... ID-Chip
- 2 ... Safety Click
- 3 ... Rounding
- 4 ... Shoulder clamping
- 5 ... Keyway for pivoted-jaw gripper

The Safety-Click has an adapted loaded bearing length for upper and lower tools. The maximum tool weight for automatic changing is 6 kg, for which reason system division A (max. 100 mm pieces) also applies.

In order to minimize the damage risk to tools and to the TIS rail, the >A< tools are rounded on the top **(3)**.

Shoulder clamping for upper and lower tools: for parts < 25 mm, the tool is designed with a 25 mm long base.

In the case of asymmetric tools, the keyway for the pivoted-jaw gripper is incorporated on both sides **(5)**.

Comparison of upper tools

 can be changed manually

 can be changed automatically

OW200/K R1/86°
Head-bearing

>A< OW200/S R1/86°
Shoulder-bearing

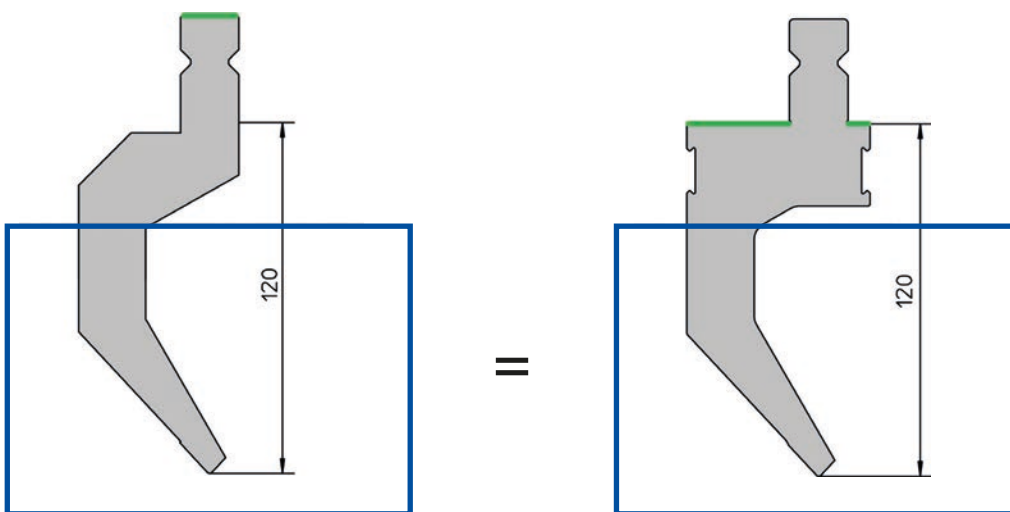

In the case of punches, the lower geometry is comparable.

Comparison of horn design

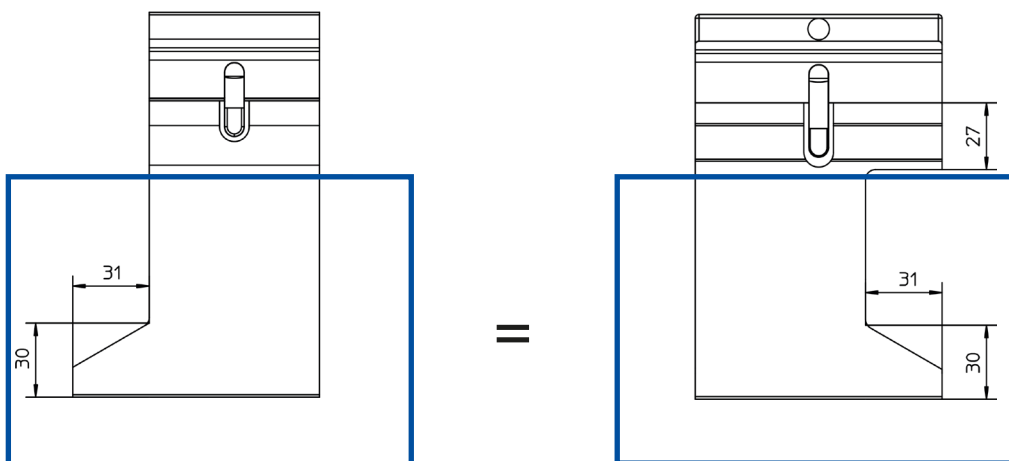

Comparison of lower tools



can be changed manually



can be changed automatically

EV/S W12/84°

>A< EV/S W12/84°

In the case of dies, the upper geometry is comparable.

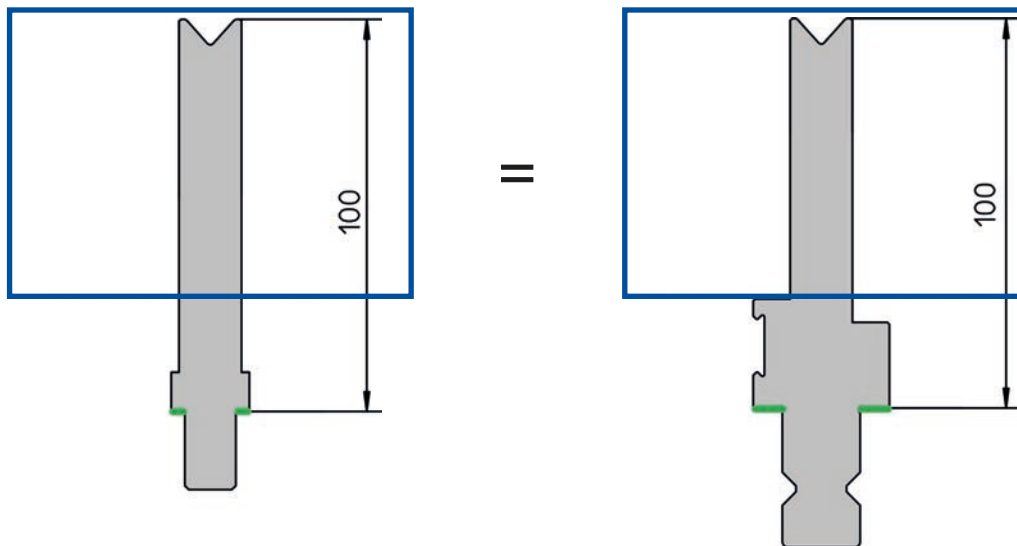

The tool adapter is identical for lower and upper tools of >A< tools.

Additional charges for the modification of standard tools

The prices for the most recent modified upper tool radii are already indicated in the catalog. The prices indicated in the extra charge table are valid from a total order length of 200 mm.

Prices for radius changes of 0.3 mm to 10 mm can be determined using the extra charge:

- For radius changes with height modification, **Extra charge 1 (modification)** is to be used.
- For radius changes without height modification, **Extra charge 2 (modification)** is to be used.

Examples of modifications

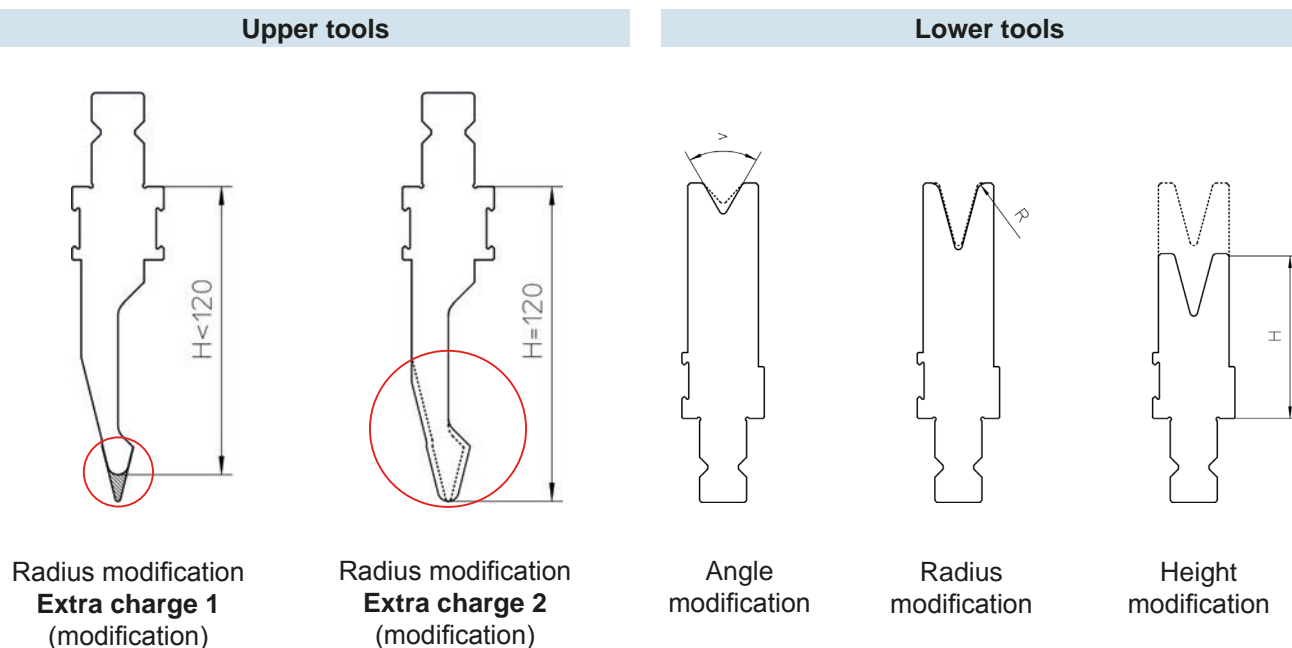

Type of modification	Extra charge	Die width
Change of radius	1	W4-W50
Height modification 50 mm	1	W4-W50/80°
Change of angle 50°- 90°	1	W4-W20
Change of angle 50°- 80°	2	W24-W30
Change of angle 60°- 80°	2	W40-W50

Extra charge table

	Lengths in [mm]	Extra charge 1	Extra charge 2	
till	100	-	-	EUR
	150	-	-	EUR
	250	-	-	EUR
	550	-	-	EUR
	1050	-	-	EUR

Calculating and requests for special shapes is best supported in the TRUMPF E-Shop!



Extra charges for LASERdur ZN coating

Coated LASERdur ZN dies are especially suited to processing galvanized sheets.

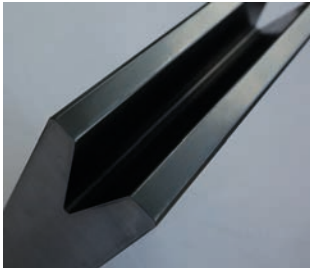

- **Dies for air bending** with a die width up to 24 mm are available with the LASERdur ZN coating.
- **Embossing dies** with a die width up to 12 mm are available with LASERdur ZN coating.
- Special tools available on request.

Lengths	Extra charge		
	Die 45° - 86°	Die 30°, 90°, >A< EV-F	
Var. A			
1050	-	-	EUR
550	-	-	EUR
Block			
250	-	-	EUR
150	-	-	EUR
Single			
100	-	-	EUR
till 50	-	-	EUR

Material selection

Material	Galvanized sheet	Mild steel	Hot-rolled steel	Aluminum	Stainless steel
Application of the coated dies					

The values of the maximum sheet thicknesses for the specific die widths may not be exceeded.

Dies for air bending

Die width	Radii	Type	Sheet thickness [mm]									
			0,5	0,7	1	1,25	1,5	1,75	2	2,5	3	3,5
W5	Standard	R0,6 >A< EV/S W5/30°										
		R0,6 >A< EV/S W5/84°										
	Special radius	R2										
W6	Standard	R0,6 >A< EV/S W6/30°										
		R0,6 >A< EV/S W6/84°										
	Special radius	R2										
W8	Standard	R1 >A< EV W8/30°										
		R0,8 >A< EV/S W8/84°										
	Special radius	R2										
W10	Standard	R1 >A< EV/S W10/30°										
		R1 >A< EV/S W10/84°										
	Special radius	R2										
W12	Standard	R1 >A> EV/S W12/30°										
		R1 >A< EV/S W12/84°										
	Special radius	R2										
W16	Standard	R1,6 >A< EV/S W16/30°										
		R1,6 >A< EV/S W16/84°										
	Special radius	R2										
W20	Standard	R2 >A< EV/S W20/30°										
	Special radius	R4										
W24	Standard	R2,5 >A< EV/S W24/30°										
	Special radius	R4										

Area of application

Area of application of preferred dies

Dies for embossing











Die width	Radii	Type	Sheet thickness [mm]						
			0,5	0,75	1	1,25	1,5	1,75	2
W6	Standard	R0,6 >A< EV/S W6/90°							
W8	Standard	R0,8 >A< EV/S W8/90°							
W10	Standard	R1 >A< EV/S W10/90°							
W12	Standard	R1 >A< EV/S W12/90°							

Area of application



You can find many variants of our high-quality TRUMPF tools on the following pages.

Explanation of symbols

	Max. load
	Folding
	Material, strength
	Weight
	Final processing working surface hardened and ground
	Max. box height
	Automation tool
	Minimum side length
	Minimum Z dimension at max. sheet thickness
	Technical information



Punch

- 800 kN/m
- 42 Cr Mo 4
1080 - 1180 N/mm²
- 32,1 kg/m
- ~60 HRC
- 64 mm
- 10 mm - 100 mm

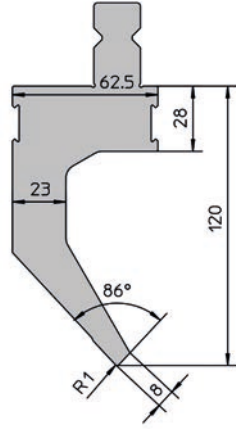

		Delivery time: 2 weeks
>A< OW200/S	Radius:	R1,0 mm
	Angle:	86°
	Height:	120 mm

Var. A	Mat. No.	Price
1050	1739369	- EUR
550	1737175	- EUR
Block 250		
250	1737174	- EUR
Single		
100	1737173	- EUR
Horn left 100	1737171	- EUR
Horn right 100	1737172	- EUR
50	1737150	- EUR
45	1737149	- EUR
40	1737148	- EUR
35	1737147	- EUR
30	1737146	- EUR
25	1737145	- EUR
20	1758699	- EUR
15	1758698	- EUR
10	1758697	- EUR

Lengths in [mm]

Punch

- 800 kN/m
- 42 Cr Mo 4
1080 - 1180 N/mm²
- 24,9 kg/m
- ~60 HRC
- 64 mm
- 10 mm - 100 mm

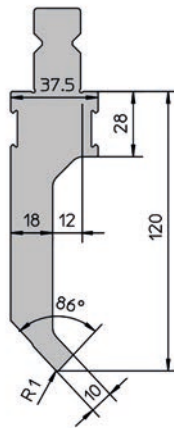

		Delivery time: 2 weeks
>A< OW201/S	Radius:	R1,0 mm
	Angle:	86°
	Height:	120 mm

Var. A	Mat. No.	Price
1050	1752700	- EUR
550	1752699	- EUR
Block 250		
250	1752698	- EUR
Single		
100	1752697	- EUR
Horn left 100	1752695	- EUR
Horn right 100	1752696	- EUR
50	1752694	- EUR
45	1752693	- EUR
40	1752692	- EUR
35	1752691	- EUR
30	1752650	- EUR
25	1752649	- EUR
20	1842239	- EUR
15	1842238	- EUR
10	1842237	- EUR

Lengths in [mm]

Punch

Delivery time: 2 weeks



600 kN/m

42 Cr Mo 4
1080 - 1180 N/mm²

20,9 kg/m



~60 HRC



64 mm



10 mm - 100 mm

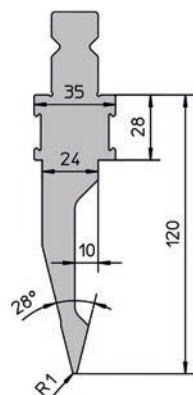

>A< OW202/S

Radius: R1,0 mm
Angle: 28°
Height: 120 mm
Mat. No. Price

Var. A

1050	1739370	- EUR
550	1737394	- EUR

Block 250

250	1737393	- EUR
-----	---------	-------

Single

Horn right 100	1737392	- EUR
Horn left 100	1737391	- EUR
100	1737390	- EUR
50	1737389	- EUR
45	1737388	- EUR
40	1737387	- EUR
35	1737386	- EUR
30	1737385	- EUR
25	1737384	- EUR
20	1756952	- EUR
15	1756951	- EUR
10	1756870	- EUR

Lengths in [mm]

Punch

Delivery time: 2 weeks



1800 kN/m

42 Cr Mo 4
1080 - 1180 N/mm²

25,6 kg/m



~60 HRC



64 mm



10 mm - 100 mm

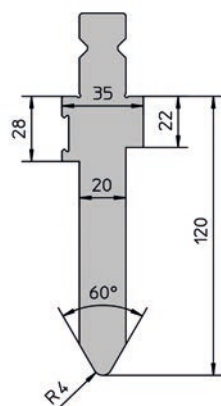

>A< OW203/S

Radius: R4,0 mm
Angle: 60°
Height: 120 mm
Mat. No. Price

Var. A

1050	1751667	- EUR
550	1751666	- EUR

Block 250

250	1751665	- EUR
-----	---------	-------

Single

Horn right 100	1751663	- EUR
Horn left 100	1751662	- EUR
100	1751664	- EUR
50	1751661	- EUR
45	1751640	- EUR
40	1751639	- EUR
35	1751638	- EUR
30	1751637	- EUR
25	1751636	- EUR
20	1824458	- EUR
15	1824457	- EUR
10	1824456	- EUR

Lengths in [mm]



Punch

- 400 kN/m
- 42 Cr Mo 4
1080 - 1180 N/mm²
- 21,0 kg/m
- ~60 HRC
- 64 mm
- 10 mm - 100 mm

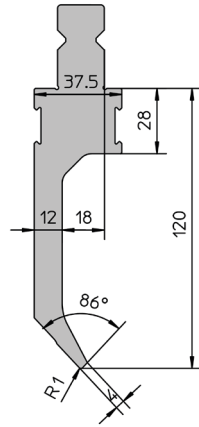

Delivery time: 2 weeks

>A< OW204/S		Radius:	R1,0 mm
		Angle:	86°
		Height:	120 mm
		Mat. No.	Price
Var. A			
1050	1993671		- EUR
550	1993600		- EUR
Block 250			
250	1993682		- EUR
Single			
100	1993678		- EUR
Horn left 100	1993683		- EUR
Horn right 100	1993684		- EUR
50	1993677		- EUR
45	1993676		- EUR
40	1993675		- EUR
35	1993674		- EUR
30	1993673		- EUR
25	1993672		- EUR
20	1993681		- EUR
15	1993680		- EUR
10	1993679		- EUR

Lengths in [mm]

Punch

- 400 kN/m
- 42 Cr Mo 4
1080 - 1180 N/mm²
- 33,2 kg/m
- ~60 HRC
- 78 mm
- 10 mm - 100 mm

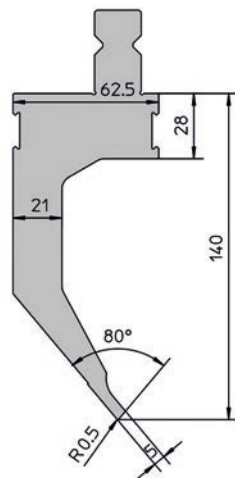

Delivery time: 2 weeks

>A< OW280/S		Radius:	R0,5 mm
		Angle:	80°
		Height:	140 mm
		Mat. No.	Price
Var. A			
1050	1751901		- EUR
550	1751900		- EUR
Block 250			
250	1751899		- EUR
Single			
100	1751898		- EUR
Horn left 100	1751896		- EUR
Horn right 100	1751897		- EUR
50	1751895		- EUR
45	1751894		- EUR
40	1751893		- EUR
35	1751892		- EUR
30	1751891		- EUR
25	1751880		- EUR
20	1759472		- EUR
15	1759471		- EUR
10	1759470		- EUR

Lengths in [mm]



Punch

Delivery time: 2 weeks

- 600 kN/m
- 42 Cr Mo 4
1080 - 1180 N/mm²
- 23,1 kg/m
- ~60 HRC
- 78 mm
- 10 mm - 100 mm

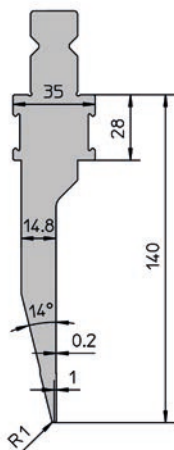

>A< OW282/S		Radius:	R1,0 mm
		Angle:	28°
		Height:	140 mm
		Mat. No.	Price
Var. A			
1050	1758237		- EUR
550	1758236		- EUR
Block 250			
250	1758235		- EUR
Single			
100	1758234		- EUR
Horn left 100	1758232		- EUR
Horn right 100	1758233		- EUR
50	1758231		- EUR
45	1758230		- EUR
40	1758229		- EUR
35	1758228		- EUR
30	1758227		- EUR
25	1758226		- EUR
20	1759248		- EUR
15	1759247		- EUR
10	1759246		- EUR

Lengths in [mm]



Punch



1800 kN/m



42 Cr Mo 4
1080 - 1180 N/mm²



25,7 kg/m



~60 HRC



64 mm



10 mm - 100 mm

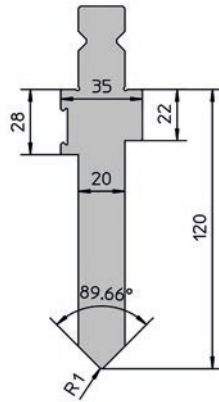

Delivery time: 2 weeks

>A< OW211/S		Radius:	R1,0 mm
		Angle:	89.66°
		Height:	120 mm
		Mat. No.	Price
Var. A			
1050	1751944		- EUR
550	1751943		- EUR
Block 250			
250	1751942		- EUR
Single			
100	1751941		- EUR
Horn left 100	1751909		- EUR
Horn right 100	1751910		- EUR
50	1751908		- EUR
45	1751907		- EUR
40	1751906		- EUR
35	1751905		- EUR
30	1751904		- EUR
25	1751903		- EUR

Lengths in [mm]

ACB Sensor tools

Sensor tool



Delivery time: 2 weeks

ACB
>A< OW202/S

Radius:	R1,0 mm
Angle:	28°
Height:	120 mm

Mat. No.	Price
----------	-------

ACB Wireless

Sensor tool 25	2086586	- EUR
----------------	---------	-------

Initial equipment	2108799	- EUR
-------------------	---------	-------

Sensor disk

L22	0912273	- EUR
-----	---------	-------

L12	0912272	- EUR
-----	---------	-------

R28	0902668	- EUR
-----	---------	-------

R19	0904178	- EUR
-----	---------	-------

R18	0901129	- EUR
-----	---------	-------

R10	0901130	- EUR
-----	---------	-------

R05	0902438	- EUR
-----	---------	-------

The sensor disks marked with a star (*) are included in the sensor tool scope of delivery.

Sensor disks >A<OW 202/S H120

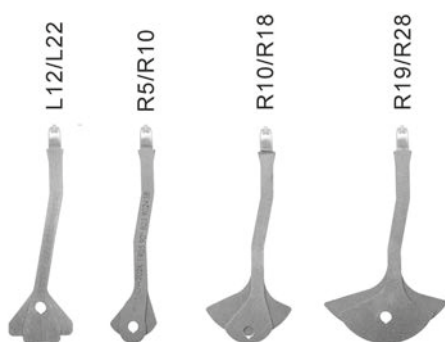

enlarged illustration

For bigger tool radii restricted angle measurements ranges are valid!

R5/R10 *

Mat.	s	W	α	R (OW)
StSt	≤ 2.5	≤ 16	75 - 95	≤ 2
St	≤ 2.5	≤ 16	75 - 105	≤ 2
Al	≤ 2.5	≤ 16	75 - 105	≤ 2

R10/R18 *

Mat.	s	W	α	R (OW)
StSt	≤ 3.0	≤ 20	80 - 100	≤ 4
St	≤ 4.0	≤ 24	80 - 105	≤ 4
Al	≤ 4.0	≤ 24	80 - 105	≤ 4

R19/R28

Mat.	s	W	α	R (OW)
StSt	≤ 6.0	≤ 50	85 - 95	≤ 6
St	≤ 10.0	≤ 70	85 - 100	≤ 6
Al	≤ 8.0	≤ 70	85 - 100	≤ 6

L12/L22

Mat.	s	W	α	R (OW)
StSt	≤ 2.5	≤ 16	105 - 135	≤ 3
St	≤ 2.5	≤ 16	105 - 135	≤ 3
Al	≤ 2.5	≤ 16	105 - 135	≤ 3



Sensor tool



Delivery time: 2 weeks

ACB >A< OW203/S

Radius:	R4,0 mm
Angle:	60°
Height:	120 mm
Mat. No.	Price

ACB Wireless

Sensor tool 25	2227312	- EUR
Initial equipment	2227316	- EUR

Sensor disk

L43	0908872	- EUR
L32	0908873	- EUR
L27	0919840	- EUR
L18	0919842	- EUR

The sensor disks marked with a star (*) are included in the sensor tool scope of delivery.

Sensor disks >A<OW 203/S H120

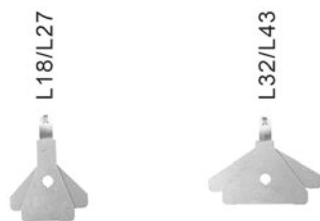

L18/L27 *

Mat.	s	W	α	R (OW)
StSt	≤ 4.0	≤ 24	85 - 105	≤ 4
St	≤ 4.0	≤ 24	85 - 105	≤ 4
Al	≤ 4.0	≤ 24	85 - 105	≤ 4

L32/L43 *

Mat.	s	W	α	R (OW)
StSt	≤ 6.0	≤ 40	85 - 95	≤ 6
St	≤ 10.0	≤ 70	85 - 95	≤ 6
Al	≤ 10.0	≤ 70	85 - 95	≤ 6

enlarged illustration

For bigger tool radii restricted angle measurements ranges are valid!



Sensor tool



Delivery time: 2 weeks

ACB >A< OW201/S		Radius:	R1,0 mm
		Angle:	86°
		Height:	120 mm
		Mat. No.	Price
ACB Wireless			
Sensor tool 25	2236085		- EUR
Initial equipment	2236089		- EUR
Sensor disk			
L22	0912271		- EUR
L12	0912270		- EUR
R28	0907795		- EUR
R19	0907796		- EUR
R18	0907792		- EUR
R10	0907793		- EUR
R05	0907794		- EUR

The sensor disks marked with a star (*) are included in the sensor tool scope of delivery.

Sensor disks >A<OW 201/S H120

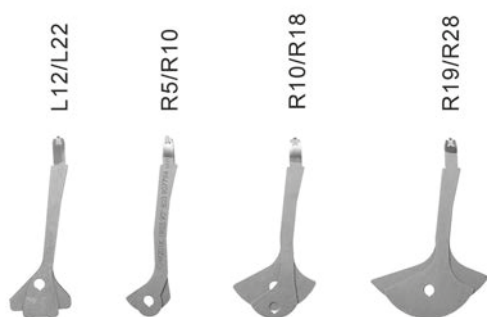

enlarged illustration

For bigger tool radii restricted angle measurements ranges are valid!

R5/R10 *				
Mat.	s	W	α	R (OW)
StSt	≤ 2.5	≤ 16	90 - 95	≤ 2
St	≤ 2.5	≤ 16	90 - 105	≤ 2
Al	≤ 2.5	≤ 16	90 - 105	≤ 2

R10/R18 *				
Mat.	s	W	α	R (OW)
StSt	≤ 3.0	≤ 20	90 - 100	≤ 4
St	≤ 4.0	≤ 24	90 - 105	≤ 4
Al	≤ 4.0	≤ 24	90 - 105	≤ 4

R19/R28				
Mat.	s	W	α	R (OW)
StSt	≤ 6.0	≤ 50	90 - 95	≤ 6
St	≤ 10.0	≤ 70	90 - 100	≤ 6
Al	≤ 8.0	≤ 70	90 - 100	≤ 6

L12/L22				
Mat.	s	W	α	R (OW)
StSt	≤ 2.5	≤ 16	105 - 135	≤ 3
St	≤ 2.5	≤ 16	105 - 135	≤ 3
Al	≤ 2.5	≤ 16	105 - 135	≤ 3



Sensor tool



Delivery time: 2 weeks

ACB >A< OW200/S

Radius:	R1,0 mm
Angle:	86°
Height:	120 mm
Mat. No.	Price

ACB Wireless

Sensor tool 25	2090760	- EUR
Initial equipment	2242830	- EUR

Sensor disk

L22	0912267	- EUR
L12	0912266	- EUR
R28	0902666	- EUR
R19	0904046	- EUR
R18	0901125	- EUR
R10	0901126	- EUR
R05	0902436	- EUR

The sensor disks marked with a star (*) are included in the sensor tool scope of delivery.

Sensor disks >A<OW 200/S H120

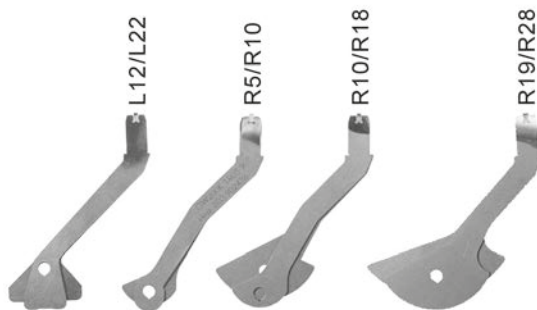

R5/R10 *

Mat.	s	W	α	R (OW)
StSt	≤ 2.5	≤ 16	90 - 95	≤ 2
St	≤ 2.5	≤ 16	90 - 105	≤ 2
Al	≤ 2.5	≤ 16	90 - 105	≤ 2

R10/R18 *

Mat.	s	W	α	R (OW)
StSt	≤ 3.0	≤ 20	90 - 100	≤ 4
St	≤ 4.0	≤ 24	90 - 105	≤ 4
Al	≤ 4.0	≤ 24	90 - 105	≤ 4

R19/R28

Mat.	s	W	α	R (OW)
StSt	≤ 6.0	≤ 50	90 - 95	≤ 6
St	≤ 10.0	≤ 70	90 - 100	≤ 6
Al	≤ 8.0	≤ 70	90 - 100	≤ 6

L12/L22

Mat.	s	W	α	R (OW)
StSt	≤ 2.5	≤ 16	105 - 135	≤ 3
St	≤ 2.5	≤ 16	105 - 135	≤ 3
Al	≤ 2.5	≤ 16	105 - 135	≤ 3

enlarged illustration

For bigger tool radii restricted angle measurements ranges are valid!



Sensor tool



Delivery time: 2 weeks

ACB		Radius:	R0,5 mm
>A< OW280/S		Angle:	80°
		Height:	140 mm
		Mat. No.	Price
ACB Wireless			
Sensor tool 25	2232432		- EUR
Initial equipment	2232436		- EUR
Sensor disk			
L14	1206832		- EUR
L10	1206830		- EUR
L08	1206831		- EUR
L05	1206829		- EUR

The sensor disks marked with a star (*) are included in the sensor tool scope of delivery.

Sensor disks >A<OW 280/S H140

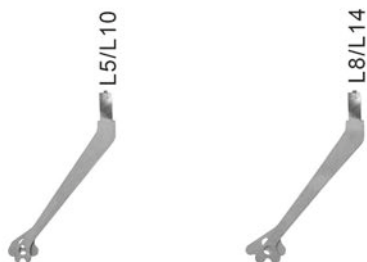

L5/L10 *				
Mat.	s	W	α	R (OW)
StSt	≤ 1.0	≤ 8	85 - 110	≤ 1.0
St	≤ 1.5	≤ 10	85 - 110	≤ 1.5
Al	≤ 1.5	≤ 10	85 - 110	≤ 1.5
L8/L14 *				
Mat.	s	W	α	R (OW)
StSt	≤ 2.0	≤ 12	85 - 110	≤ 2.0
St	≤ 2.5	≤ 16	85 - 110	≤ 2.5
Al	≤ 2.5	≤ 16	85 - 110	≤ 2.5

enlarged illustration

For bigger tool radii restricted angle measurements ranges are valid!

Sensor tool



Delivery time: 2 weeks

ACB >A< OW282/S

Radius:	R1,0 mm
Angle:	28°
Height:	140 mm
Mat. No.	Price

ACB Wireless

Sensor tool 25	2232397	- EUR
Initial equipment	2232411	- EUR

Sensor disk

L22	0912273	- EUR
L12	0912272	- EUR
R28	0902668	- EUR
R19	0904178	- EUR
R18	0901129	- EUR
R10	0901130	- EUR
R05	0902438	- EUR

The sensor disks marked with a star (*) are included in the sensor tool scope of delivery.

Sensor disks >A<OW 282/S H140

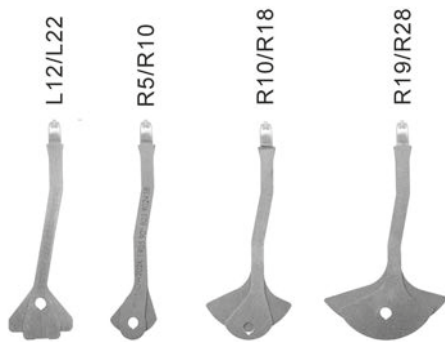

R5/R10 *

Mat.	s	W	α	R (OW)
StSt	≤ 2.5	≤ 16	75 - 95	≤ 2
St	≤ 2.5	≤ 16	75 - 105	≤ 2
Al	≤ 2.5	≤ 16	75 - 105	≤ 2

R10/R18 *

Mat.	s	W	α	R (OW)
StSt	≤ 3.0	≤ 20	80 - 100	≤ 4
St	≤ 4.0	≤ 24	80 - 105	≤ 4
Al	≤ 4.0	≤ 24	80 - 105	≤ 4

R19/R28

Mat.	s	W	α	R (OW)
StSt	≤ 6.0	≤ 50	85 - 95	≤ 6
St	≤ 10.0	≤ 70	85 - 100	≤ 6
Al	≤ 8.0	≤ 70	85 - 100	≤ 6

L12/L22

Mat.	s	W	α	R (OW)
StSt	≤ 2.5	≤ 16	105 - 135	≤ 3
St	≤ 2.5	≤ 16	105 - 135	≤ 3
Al	≤ 2.5	≤ 16	105 - 135	≤ 3

enlarged illustration

For bigger tool radii restricted angle measurements ranges are valid!

Folding

Punch

Delivery time: 2 weeks



400 kN/m



1000 kN/m

42 Cr Mo 4
1080 - 1180 N/mm²

22,9 kg/m



~60 HRC



78 mm



25 mm - 100 mm

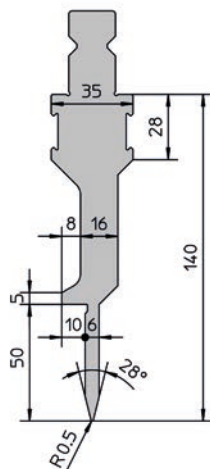

>A< OW215/S

Radius: R0,5 mm

Angle: 28°

Height: 140 mm

Mat. No. Price

Var. A

1050 1763921 - EUR

550 1763920 - EUR

Block 250

250 1763919 - EUR

Single

100 1763916 - EUR

Horn left 100 1763918 - EUR

Horn right 100 1763917 - EUR

50 1763915 - EUR

45 1763914 - EUR

40 1763913 - EUR

35 1763912 - EUR

30 1763911 - EUR

25 1763880 - EUR

Lengths in [mm]

Die

Delivery time: 2 weeks



300 kN/m

42 Cr Mo 4
1080 - 1180 N/mm²

27,6 kg/m



~60 HRC



25 mm - 100 mm

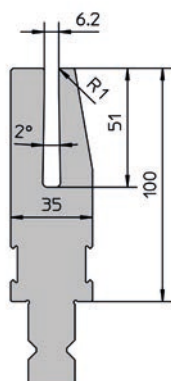

>A< EV-F W6,2

Die width: 6,2 mm

Angle: 30°

Height: 100 mm

Mat. No. Price

Var. A

1050 1764104 - EUR

550 1764103 - EUR

Block 250

250 1764102 - EUR

Single

100 1764101 - EUR

50 1764080 - EUR

45 1764079 - EUR

40 1764078 - EUR

35 1764077 - EUR

30 1764076 - EUR

25 1764075 - EUR

Lengths in [mm]



Die



350 kN/m



42 Cr Mo 4
1080 - 1180 N/mm²



27,7 kg/m



~60 HRC



25 mm - 100 mm



6,3 mm

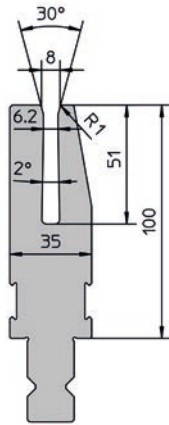

Delivery time: 2 weeks

>A< EV-F W8

Die width: 8 mm
Angle: 30°
Height: 100 mm
Mat. No. Price

Var. A

1050	1813842	- EUR
550	1813841	- EUR

Block 250

250	1813850	- EUR
-----	---------	-------

Single

100	1813849	- EUR
50	1813848	- EUR
45	1813847	- EUR
40	1813846	- EUR
35	1813845	- EUR
30	1813844	- EUR
25	1813843	- EUR

Lengths in [mm]

Die



350 kN/m



42 Cr Mo 4
1080 - 1180 N/mm²



27,6 kg/m



~60 HRC



25 mm - 100 mm



7,8 mm

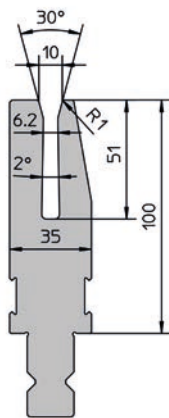

Delivery time: 2 weeks

>A< EV-F W10

Die width: 10 mm
Angle: 30°
Height: 100 mm
Mat. No. Price

Var. A

1050	1813872	- EUR
550	1813871	- EUR

Block 250

250	1813880	- EUR
-----	---------	-------

Single

100	1813879	- EUR
50	1813878	- EUR
45	1813877	- EUR
40	1813876	- EUR
35	1813875	- EUR
30	1813874	- EUR
25	1813873	- EUR

Lengths in [mm]

4 mm die width

Die

Delivery time: 2 weeks



150 kN/m

42 Cr Mo 4
1080 - 1180 N/mm²

17,2 kg/m



~60 HRC



10 mm - 100 mm



3,3 mm



4,9mm (s=0,9mm)

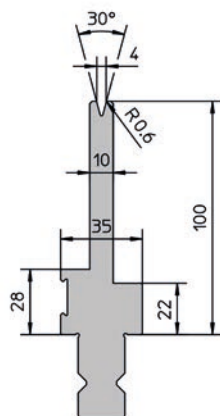

>A< EV/S W4/30°

Die width: 4 mm
 Angle: 30°
 Height: 100 mm
 Mat. No. Price

Var. A

1050	1756412	- EUR
550	1756411	- EUR

Block 250

250	1756410	- EUR
-----	---------	-------

Single

100	1756409	- EUR
50	1756408	- EUR
45	1756407	- EUR
40	1756406	- EUR
35	1756405	- EUR
30	1756404	- EUR
25	1756403	- EUR

Lengths in [mm]

Die

Delivery time: 2 weeks



250 kN/m

42 Cr Mo 4
1080 - 1180 N/mm²

16,1 kg/m



~60 HRC



10 mm - 100 mm



3,1 mm



3,8mm (s=1mm)

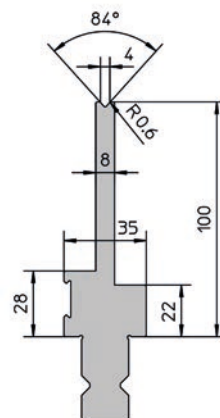

>A< EV/S W4/84°

Die width: 4 mm
 Angle: 84°
 Height: 100 mm
 Mat. No. Price

Var. A

1050	1756986	- EUR
550	1756985	- EUR

Block 250

250	1756984	- EUR
-----	---------	-------

Single

100	1756983	- EUR
50	1756982	- EUR
45	1756981	- EUR
40	1756960	- EUR
35	1756959	- EUR
30	1756958	- EUR
25	1756957	- EUR

Lengths in [mm]



5 mm die width

Die



250 kN/m

42 Cr Mo 4
1080 - 1180 N/mm²

16,1 kg/m



~60 HRC



10 mm - 100 mm



3,1 mm



3,8mm (s=1mm)

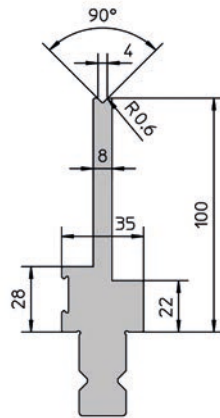

Delivery time: 2 weeks

>A< EV/S W4/90°	Die width:	4 mm
	Angle:	90°
	Height:	100 mm
Mat. No.	Price	
Var. A		
1050	1757017	- EUR
550	1757016	- EUR
Block 250		
250	1757015	- EUR
Single		
100	1757014	- EUR
50	1757013	- EUR
45	1757012	- EUR
40	1757011	- EUR
35	1757000	- EUR
30	1756999	- EUR
25	1756998	- EUR

Lengths in [mm]

Die



150 kN/m

42 Cr Mo 4
1080 - 1180 N/mm²

17,2 kg/m



~60 HRC



10 mm - 100 mm



4,1 mm



5mm (s=1mm)

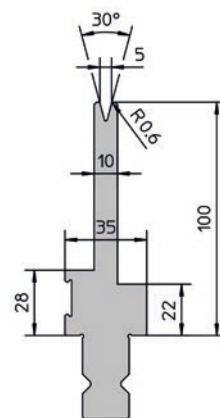

Delivery time: 2 weeks

>A< EV/S W5/30°	Die width:	5 mm
	Angle:	30°
	Height:	100 mm
Mat. No.	Price	
Var. A		
1050	1756761	- EUR
550	1756760	- EUR
Block 250		
250	1756759	- EUR
Single		
100	1756758	- EUR
50	1756757	- EUR
45	1756756	- EUR
40	1756755	- EUR
35	1756754	- EUR
30	1756753	- EUR
25	1756752	- EUR

Lengths in [mm]



Die

Delivery time: 2 weeks



250 kN/m

42 Cr Mo 4
1080 - 1180 N/mm²

16,1 kg/m



~60 HRC



10 mm - 100 mm



3,8 mm



3,7mm (s=1,25mm)

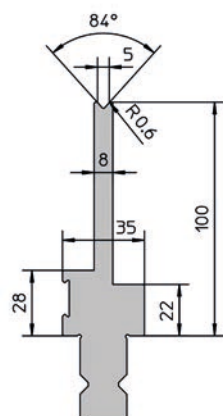

>A< EV/S W5/84°

Die width: 5 mm

Angle: 84°

Height: 100 mm

Mat. No. Price

Var. A

1050 1756996 - EUR

550 1756995 - EUR

Block 250

250 1756994 - EUR

Single

100 1756993 - EUR

50 1756992 - EUR

45 1756991 - EUR

40 1756990 - EUR

35 1756989 - EUR

30 1756988 - EUR

25 1756987 - EUR

Lengths in [mm]

Die

Delivery time: 2 weeks



390 kN/m

42 Cr Mo 4
1080 - 1180 N/mm²

17,3 kg/m



~60 HRC



10 mm - 100 mm



3,8 mm



4,7mm (s=1,25mm)

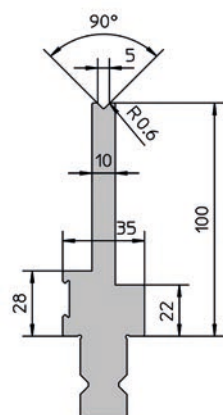

>A< EV/S W5/90°

Die width: 5 mm

Angle: 90°

Height: 100 mm

Mat. No. Price

Var. A

1050 1757196 - EUR

550 1757195 - EUR

Block 250

250 1757194 - EUR

Single

100 1757193 - EUR

50 1757192 - EUR

45 1757191 - EUR

40 1757190 - EUR

35 1757189 - EUR

30 1757188 - EUR

25 1757187 - EUR

Lengths in [mm]



6 mm die width

Die

Delivery time: 2 weeks



170 kN/m



42 Cr Mo 4
1080 - 1180 N/mm²



18,3 kg/m



~60 HRC



10 mm - 100 mm



4,8 mm



6,2mm (s=1mm)

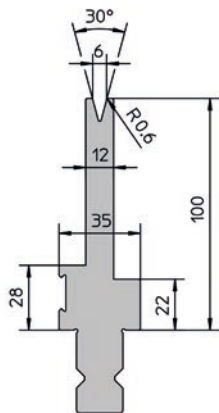

>A< EV/S W6/30°

Die width: 6 mm
Angle: 30°
Height: 100 mm
Mat. No.

Price

Var. A

1050	1751310	- EUR
550	1751309	- EUR

Block 250

250	1751308	- EUR
-----	---------	-------

Single

100	1751307	- EUR
50	1751306	- EUR
45	1751305	- EUR
40	1751304	- EUR
35	1751303	- EUR
30	1751302	- EUR
25	1751301	- EUR
20	1758654	- EUR
15	1758653	- EUR
10	1758651	- EUR

Lengths in [mm]

Die

Delivery time: 2 weeks



400 kN/m



42 Cr Mo 4
1080 - 1180 N/mm²



22,8 kg/m



~60 HRC



10 mm - 100 mm



6,4 mm



9,8mm (s=1,5mm)

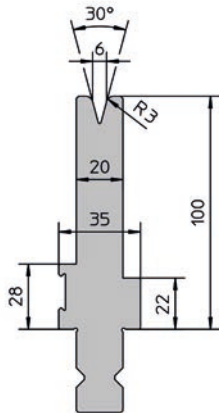

>A< EV W6/30°
R3

Die width: 6 mm
Angle: 30°
Height: 100 mm
Mat. No.

Price

Var. A

1050	1757698	- EUR
550	1757697	- EUR

Block 250

250	1757696	- EUR
-----	---------	-------

Single

100	1757695	- EUR
50	1757694	- EUR
45	1757693	- EUR
40	1757692	- EUR
35	1757691	- EUR
30	1757650	- EUR
25	1757649	- EUR
20	1842252	- EUR
15	1842251	- EUR
10	1842240	- EUR

Lengths in [mm]



Die

Delivery time: 2 weeks



250 kN/m

42 Cr Mo 4
1080 - 1180 N/mm²

17,3 kg/m



~60 HRC



10 mm - 100 mm



4,5 mm



5,2mm (s=1,25mm)

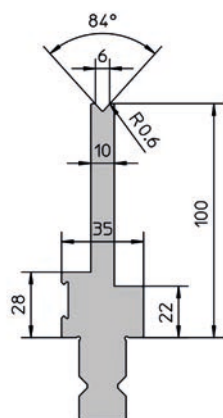

>A< EV/S W6/84°

Die width: 6 mm
 Angle: 84°
 Height: 100 mm
 Mat. No. Price

Var. A

1050	1739411	- EUR
550	1736976	- EUR

Block 250

250	1736975	- EUR
-----	---------	-------

Single

100	1736974	- EUR
50	1736973	- EUR
45	1736972	- EUR
40	1736971	- EUR
35	1736930	- EUR
30	1736929	- EUR
25	1736928	- EUR
20	1758660	- EUR
15	1758659	- EUR
10	1758658	- EUR

Lengths in [mm]

Die

Delivery time: 2 weeks



390 kN/m

42 Cr Mo 4
1080 - 1180 N/mm²

17,3 kg/m



~60 HRC



10 mm - 100 mm



4,5 mm



5,2mm (s=1,5mm)

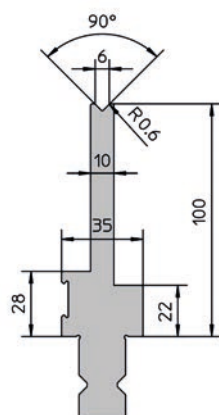

>A< EV/S W6/90°

Die width: 6 mm
 Angle: 90°
 Height: 100 mm
 Mat. No. Price

Var. A

1050	1755959	- EUR
550	1755958	- EUR

Block 250

250	1755957	- EUR
-----	---------	-------

Single

100	1755956	- EUR
50	1755955	- EUR
45	1755954	- EUR
40	1755953	- EUR
35	1755952	- EUR
30	1755951	- EUR
25	1755910	- EUR

Lengths in [mm]



8 mm die width

Die

Delivery time: 2 weeks



200 kN/m

42 Cr Mo 4
1080 - 1180 N/mm²

19,2 kg/m



~60 HRC



10 mm - 100 mm



6,3 mm



7,6mm (s=1,5mm)

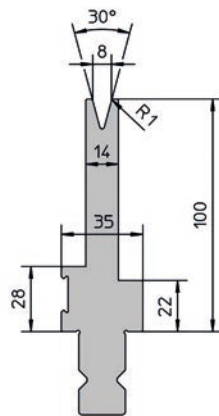

>A< EV/S W8/30°

Die width: 8 mm

Angle: 30°

Height: 100 mm

Mat. No. Price

Var. A

1050 1751476 - EUR

550 1751475 - EUR

Block 250

250 1751474 - EUR

Single

100 1751473 - EUR

50 1751472 - EUR

45 1751471 - EUR

40 1751350 - EUR

35 1751349 - EUR

30 1751348 - EUR

25 1751347 - EUR

20 1758657 - EUR

15 1758656 - EUR

10 1758655 - EUR

Lengths in [mm]

Die

Delivery time: 2 weeks



400 kN/m

42 Cr Mo 4
1080 - 1180 N/mm²

22,6 kg/m



~60 HRC



10 mm - 100 mm



8,0 mm

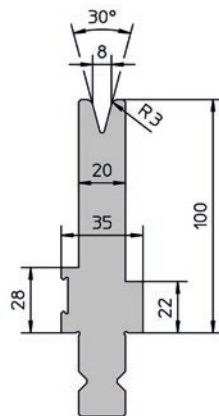

10mm (s=2mm)

>A< EV W8/30°
R3

Die width: 8 mm

Angle: 30°

Height: 100 mm

Mat. No. Price

Var. A

1050 1757791 - EUR

550 1757790 - EUR

Block 250

250 1757789 - EUR

Single

100 1757788 - EUR

50 1757787 - EUR

45 1757786 - EUR

40 1757785 - EUR

35 1757784 - EUR

30 1757783 - EUR

25 1757782 - EUR

20 1842255 - EUR

15 1842254 - EUR

10 1842253 - EUR

Lengths in [mm]



Die

Delivery time: 2 weeks



350 kN/m

42 Cr Mo 4
1080 - 1180 N/mm²

18,4 kg/m



~60 HRC



10 mm - 100 mm



5,7 mm



6,6mm (s=1,5mm)

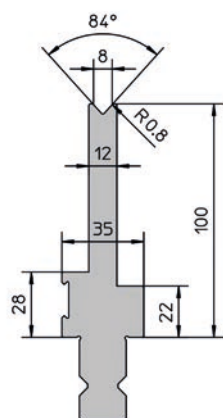

>A< EV/S W8/84°

Die width: 8 mm
 Angle: 84°
 Height: 100 mm
 Mat. No. Price

Var. A

1050	1739412	- EUR
550	1737476	- EUR

Block 250

250	1737475	- EUR
-----	---------	-------

Single

100	1737474	- EUR
50	1737473	- EUR
45	1737472	- EUR
40	1737471	- EUR
35	1737460	- EUR
30	1737459	- EUR
25	1737458	- EUR
20	1757555	- EUR
15	1757554	- EUR
10	1757553	- EUR

Lengths in [mm]

Die

Delivery time: 2 weeks



460 kN/m

42 Cr Mo 4
1080 - 1180 N/mm²

18,4 kg/m



~60 HRC



10 mm - 100 mm



5,7 mm



6,6mm (s=2mm)

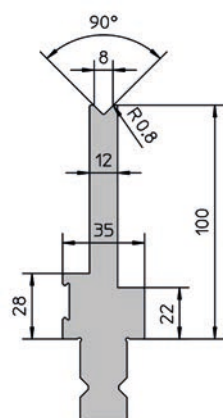

>A< EV/S W8/90°

Die width: 8 mm
 Angle: 90°
 Height: 100 mm
 Mat. No. Price

Var. A

1050	1756025	- EUR
550	1756024	- EUR

Block 250

250	1756023	- EUR
-----	---------	-------

Single

100	1756022	- EUR
50	1756021	- EUR
45	1755970	- EUR
40	1755969	- EUR
35	1755968	- EUR
30	1755967	- EUR
25	1755966	- EUR

Lengths in [mm]



10 mm die width

Die

Delivery time: 2 weeks



200 kN/m



42 Cr Mo 4
1080 - 1180 N/mm²



20,1 kg/m



~60 HRC



10 mm - 100 mm



7,8 mm



8,1mm (s=1,5mm)

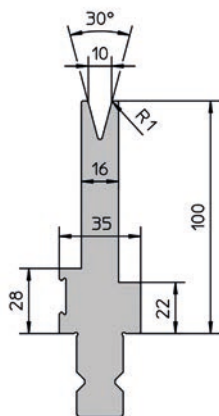

>A< EV/S
W10/30°

Die width: 10 mm

Angle: 30°

Height: 100 mm

Mat. No. Price

Var. A

1050 1751509 - EUR

550 1751508 - EUR

Block 250

250 1751507 - EUR

Single

100 1751506 - EUR

50 1751505 - EUR

45 1751504 - EUR

40 1751503 - EUR

35 1751502 - EUR

30 1751501 - EUR

25 1751480 - EUR

20 1824530 - EUR

15 1824529 - EUR

10 1824528 - EUR

Lengths in [mm]

Die

Delivery time: 2 weeks



400 kN/m



42 Cr Mo 4
1080 - 1180 N/mm²



22,3 kg/m



~60 HRC



10 mm - 100 mm



9,5 mm



10mm (s=2mm)

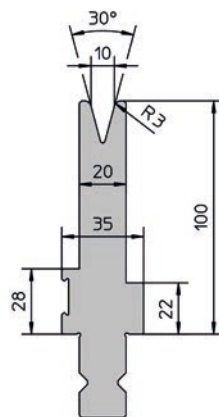

>A< EV W10/30°
R3

Die width: 10 mm

Angle: 30°

Height: 100 mm

Mat. No. Price

Var. A

1050 1757845 - EUR

550 1757844 - EUR

Block 250

250 1757843 - EUR

Single

100 1757842 - EUR

50 1757841 - EUR

45 1757800 - EUR

40 1757799 - EUR

35 1757798 - EUR

30 1757797 - EUR

25 1757796 - EUR

20 1842258 - EUR

15 1842257 - EUR

10 1842256 - EUR

Lengths in [mm]



Die

Delivery time: 2 weeks

- 400 kN/m
- 42 Cr Mo 4
1080 - 1180 N/mm²
- 19,5 kg/m
- ~60 HRC
- 10 mm - 100 mm
- 7,1 mm
- 7,3mm (s=2mm)

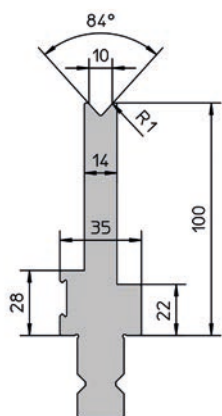

>A< EV/S
W10/84°

Die width: 10 mm
Angle: 84°
Height: 100 mm
Mat. No.

Price

Var. A		
1050	1739414	- EUR
550	1737710	- EUR
Block 250		
250	1737709	- EUR
Single		
100	1737708	- EUR
50	1737707	- EUR
45	1737706	- EUR
40	1737705	- EUR
35	1737704	- EUR
30	1737703	- EUR
25	1737702	- EUR
20	1758693	- EUR
15	1758692	- EUR
10	1758691	- EUR

Lengths in [mm]

Die

Delivery time: 2 weeks

- 530 kN/m
- 42 Cr Mo 4
1080 - 1180 N/mm²
- 19,5 kg/m
- ~60 HRC
- 10 mm - 100 mm
- 7,0 mm
- 7,3mm (s=2,5mm)

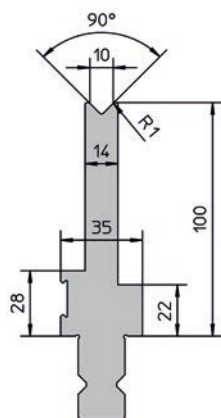

>A< EV/S
W10/90°

Die width: 10 mm
Angle: 90°
Height: 100 mm
Mat. No.

Price

Var. A		
1050	1756104	- EUR
550	1756103	- EUR
Block 250		
250	1756102	- EUR
Single		
100	1756101	- EUR
50	1756070	- EUR
45	1756069	- EUR
40	1756068	- EUR
35	1756067	- EUR
30	1756066	- EUR
25	1756065	- EUR

Lengths in [mm]



12 mm die width

Die

Delivery time: 2 weeks



250 kN/m



42 Cr Mo 4
1080 - 1180 N/mm²



21,0 kg/m



~60 HRC



10 mm - 100 mm



9,3 mm



9,2mm (s=2mm)

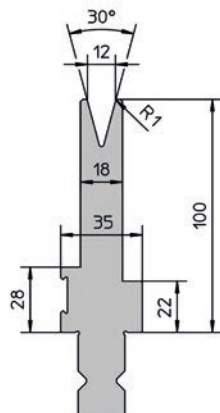

>A< EV/S
W12/30°

Die width: 12 mm

Angle: 30°

Height: 100 mm

Mat. No. Price

Var. A

1050 1751554 - EUR

550 1751553 - EUR

Block 250

250 1751552 - EUR

Single

100 1751551 - EUR

50 1751520 - EUR

45 1751519 - EUR

40 1751518 - EUR

35 1751517 - EUR

30 1751516 - EUR

25 1751515 - EUR

20 1824559 - EUR

15 1824558 - EUR

10 1824557 - EUR

Lengths in [mm]

Die

Delivery time: 2 weeks



400 kN/m



42 Cr Mo 4
1080 - 1180 N/mm²



25,0 kg/m



~60 HRC



10 mm - 100 mm



10,3 mm



12,4mm (s=2,5mm)

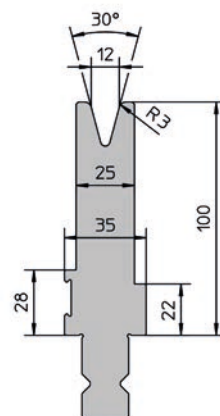

>A< EV W12/30°
R3

Die width: 12 mm

Angle: 30°

Height: 100 mm

Mat. No. Price

Var. A

1050 1757985 - EUR

550 1757984 - EUR

Block 250

250 1757983 - EUR

Single

100 1757982 - EUR

50 1757981 - EUR

45 1757960 - EUR

40 1757959 - EUR

35 1757958 - EUR

30 1757957 - EUR

25 1757956 - EUR

20 1842261 - EUR

15 1842260 - EUR

10 1842259 - EUR

Lengths in [mm]



Die

Delivery time: 2 weeks



400 kN/m

42 Cr Mo 4
1080 - 1180 N/mm²

20,5 kg/m



~60 HRC



10 mm - 100 mm



8,2 mm

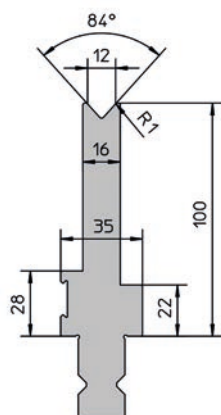

8,1mm (s=2,5mm)

>A< EV/S
W12/84°

Die width: 12 mm

Angle: 84°

Height: 100 mm

Mat. No. Price

Var. A

1050 1751206 - EUR

550 1751205 - EUR

Block 250

250 1751204 - EUR

Single

100 1751203 - EUR

50 1751202 - EUR

45 1751201 - EUR

40 1751180 - EUR

35 1751179 - EUR

30 1751178 - EUR

25 1751177 - EUR

20 1758696 - EUR

15 1758695 - EUR

10 1758694 - EUR

Lengths in [mm]

Die

Delivery time: 2 weeks



550 kN/m

42 Cr Mo 4
1080 - 1180 N/mm²

20,6 kg/m



~60 HRC



10 mm - 100 mm



8,2 mm

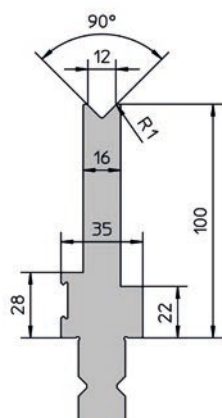

8,1mm (s=2,5mm)

>A< EV/S
W12/90°

Die width: 12 mm

Angle: 90°

Height: 100 mm

Mat. No. Price

Var. A

1050 1756145 - EUR

550 1756144 - EUR

Block 250

250 1756143 - EUR

Single

100 1756142 - EUR

50 1756141 - EUR

45 1756140 - EUR

40 1756139 - EUR

35 1756138 - EUR

30 1756137 - EUR

25 1756136 - EUR

Lengths in [mm]



16 mm die width

Die

Delivery time: 2 weeks



500 kN/m



42 Cr Mo 4
1080 - 1180 N/mm²



27,1 kg/m



~60 HRC



10 mm - 100 mm



12,1 mm



15,1mm (s=3mm)

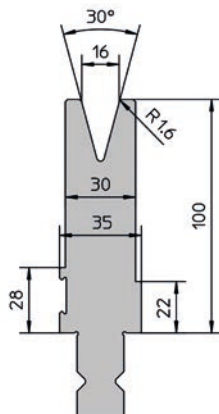

>A< EV W16/30°

Die width: 16 mm
Angle: 30°
Height: 100 mm
Mat. No. **Price**

Var. A

1050	1753165	- EUR
550	1753164	- EUR

Block 250

250	1753163	- EUR
-----	---------	-------

Single

100	1753162	- EUR
50	1753161	- EUR
45	1753050	- EUR
40	1753049	- EUR
35	1753048	- EUR
30	1753047	- EUR
25	1753046	- EUR

Lengths in [mm]

Die

Delivery time: 2 weeks



500 kN/m



42 Cr Mo 4
1080 - 1180 N/mm²



27,0 kg/m



~60 HRC



10 mm - 100 mm



13,5 mm



15,1mm (s=3mm)

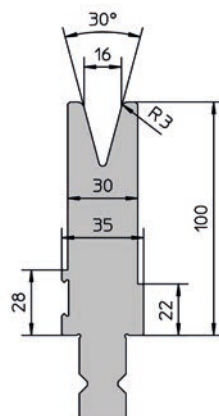

>A< EV W16/30°
R3

Die width: 16 mm
Angle: 30°
Height: 100 mm
Mat. No. **Price**

Var. A

1050	1758016	- EUR
550	1758015	- EUR

Block 250

250	1758014	- EUR
-----	---------	-------

Single

100	1758013	- EUR
50	1758012	- EUR
45	1758011	- EUR
40	1757990	- EUR
35	1757989	- EUR
30	1757988	- EUR
25	1757987	- EUR

Lengths in [mm]



Die

Delivery time: 2 weeks



700 kN/m

42 Cr Mo 4
1080 - 1180 N/mm²

28,5 kg/m



~60 HRC



10 mm - 100 mm



11,1 mm



15,1mm (s=4mm)

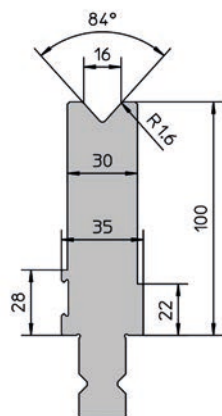

>A< EV W16/84°		Die width:	16 mm
		Angle:	84°
		Height:	100 mm
		Mat. No.	Price
Var. A			
1050	1755610		- EUR
550	1755609		- EUR
Block 250			
250	1755608		- EUR
Single			
100	1755607		- EUR
50	1755606		- EUR
45	1755605		- EUR
40	1755604		- EUR
35	1755603		- EUR
30	1755602		- EUR
25	1755601		- EUR

Lengths in [mm]



20 mm die width

Die

Delivery time: 2 weeks



600 kN/m

42 Cr Mo 4
1080 - 1180 N/mm²

29,0 kg/m



~60 HRC



10 mm - 100 mm



15,7 mm



17,3mm (s=4mm)

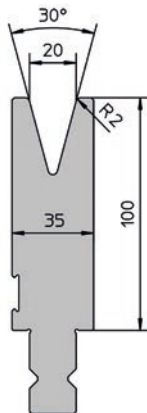

>A< EV W20/30°

Die width: 20 mm
 Angle: 30°
 Height: 100 mm
 Mat. No. Price

Var. A

1050	1753229	- EUR
550	1753228	- EUR

Block 250

250	1753227	- EUR
-----	---------	-------

Single

100	1753226	- EUR
50	1753225	- EUR
45	1753224	- EUR
40	1753223	- EUR
35	1753222	- EUR
30	1753221	- EUR
25	1753200	- EUR

Lengths in [mm]

Die

Delivery time: 2 weeks



700 kN/m

42 Cr Mo 4
1080 - 1180 N/mm²

28,2 kg/m



~60 HRC



10 mm - 100 mm



14,5 mm



14,9mm (s=4mm)

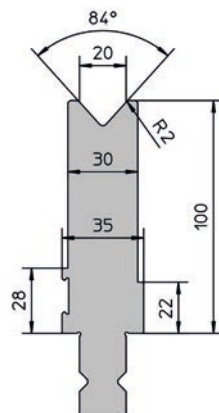

>A< EV W20/84°

Die width: 20 mm
 Angle: 84°
 Height: 100 mm
 Mat. No. Price

Var. A

1050	1755660	- EUR
550	1755659	- EUR

Block 250

250	1755658	- EUR
-----	---------	-------

Single

100	1755657	- EUR
50	1755656	- EUR
45	1755655	- EUR
40	1755654	- EUR
35	1755653	- EUR
30	1755652	- EUR
25	1755651	- EUR

Lengths in [mm]

24 mm die width

Die

Delivery time: 2 weeks



650 kN/m

42 Cr Mo 4
1080 - 1180 N/mm²

31,4 kg/m



~60 HRC



25 mm - 100 mm



19,1 mm



20mm (s=5mm)

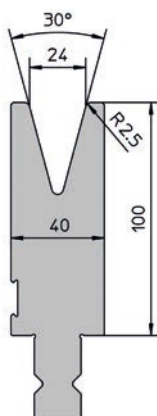

>A< EV W24/30°

Die width: 24 mm

Angle: 30°

Height: 100 mm

Mat. No. Price

Var. A

1050 1753267 - EUR

550 1753266 - EUR

Block 250

250 1753265 - EUR

Single

100 1753264 - EUR

50 1753263 - EUR

45 1753262 - EUR

40 1753261 - EUR

35 1753240 - EUR

30 1753239 - EUR

25 1753238 - EUR

Lengths in [mm]

Die

Delivery time: 2 weeks



700 kN/m

42 Cr Mo 4
1080 - 1180 N/mm²

30,6 kg/m



~60 HRC



25 mm - 100 mm



19,0 mm



18mm (s=5mm)

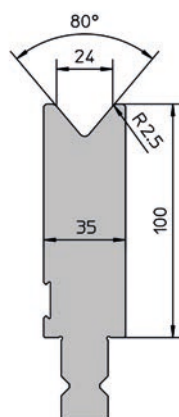

>A< EV W24/80°

Die width: 24 mm

Angle: 80°

Height: 100 mm

Mat. No. Price

Var. A

1050 1755768 - EUR

550 1755767 - EUR

Block 250

250 1755766 - EUR

Single

100 1755765 - EUR

50 1755764 - EUR

45 1755763 - EUR

40 1755762 - EUR

35 1755761 - EUR

30 1755730 - EUR

25 1755729 - EUR

Lengths in [mm]



30 mm die width

Die

Delivery time: 2 weeks



900 kN/m



42 Cr Mo 4
1080 - 1180 N/mm²



40,5 kg/m



~60 HRC



25 mm - 100 mm



23,0 mm



27,8mm (s=6mm)

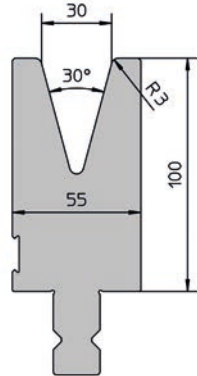

>A< EV W30/30°

Die width: 30 mm

Angle: 30°

Height: 100 mm

Mat. No. Price

Var. A

1050	1757367	- EUR
550	1757366	- EUR

Block 250

250	1757365	- EUR
-----	---------	-------

Single

100	1757364	- EUR
50	1757363	- EUR
45	1757362	- EUR
40	1757361	- EUR
35	1757340	- EUR
30	1757339	- EUR
25	1757338	- EUR

Lengths in [mm]

Die

Delivery time: 2 weeks



900 kN/m



42 Cr Mo 4
1080 - 1180 N/mm²



37,2 kg/m



~60 HRC



25 mm - 100 mm



23,7 mm



23,6mm (s=6mm)

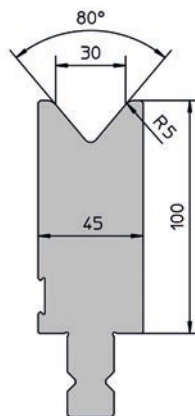

>A< EV W30/80°

Die width: 30 mm

Angle: 80°

Height: 100 mm

Mat. No. Price

Var. A

1050	1753390	- EUR
550	1753389	- EUR

Block 250

250	1753388	- EUR
-----	---------	-------

Single

100	1753387	- EUR
50	1753386	- EUR
45	1753385	- EUR
40	1753384	- EUR
35	1753383	- EUR
30	1753382	- EUR
25	1753381	- EUR

Lengths in [mm]

40 mm die width

Die

Delivery time: 2 weeks



900 kN/m

42 Cr Mo 4
1080 - 1180 N/mm²

38,9 kg/m



~60 HRC



25 mm - 100 mm



31,5 mm



32mm (s=6mm)

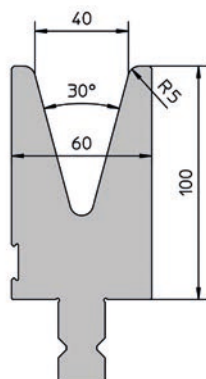

>A< EV W40/30°

Die width: 40 mm

Angle: 30°

Height: 100 mm

Mat. No. Price

Var. A

1050 1757403 - EUR

550 1757402 - EUR

Block 250

250 1757401 - EUR

Single

100 1757390 - EUR

50 1757389 - EUR

45 1757388 - EUR

40 1757387 - EUR

35 1757386 - EUR

30 1757385 - EUR

25 1757384 - EUR

Lengths in [mm]

Die

Delivery time: 2 weeks



1200 kN/m

42 Cr Mo 4
1080 - 1180 N/mm²

43,2 kg/m



~60 HRC



25 mm - 100 mm



29,8 mm



29mm (s=6mm)

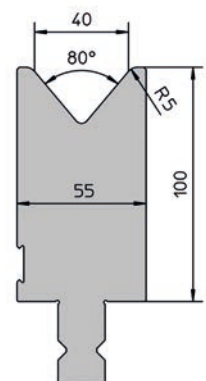

>A< EV W40/80°

Die width: 40 mm

Angle: 80°

Height: 100 mm

Mat. No. Price

Var. A

1050 1755834 - EUR

550 1755833 - EUR

Block 250

250 1755832 - EUR

Single

100 1755831 - EUR

50 1755830 - EUR

45 1755829 - EUR

40 1755828 - EUR

35 1755827 - EUR

30 1755826 - EUR

25 1755825 - EUR

Lengths in [mm]



50 mm die width

Die

Delivery time: 2 weeks



1500 kN/m



42 Cr Mo 4
1080 - 1180 N/mm²



48,7 kg/m



~60 HRC



25 mm - 100 mm



34,5 mm



37mm (s=10mm)

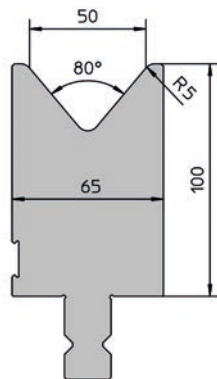

>A< EV W50/80°

Die width: 50 mm

Angle: 80°

Height: 100 mm

Mat. No. Price

Var. A

1050 1739416 - EUR

550 1738467 - EUR

Block 250

250 1738466 - EUR

Single

100 1738465 - EUR

50 1738464 - EUR

45 1738463 - EUR

40 1738462 - EUR

35 1738461 - EUR

30 1738450 - EUR

25 1738449 - EUR

Lengths in [mm]

RollBend

RollBend

Delivery time: on request



1000 kN/m

42 Cr Mo 4
1080 - 1180 N/mm²

22,6 kg/m



~60 HRC



6,1 mm

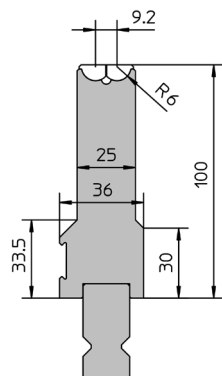

12,1mm (s=2mm)

RB 200 + EV W8/84°; Lengths 25,
30, 35, 40 und 45 available upon
request.

>A< RB 200

Die width: 8 mm

Angle: -

Height: 100 mm

Mat. No. Price

Single

100 1835701 - EUR

50 1835700 - EUR

Lengths in [mm]

RollBend

Delivery time: on request



1300 kN/m

42 Cr Mo 4
1080 - 1180 N/mm²

31,1 kg/m



~60 HRC



8,5 mm

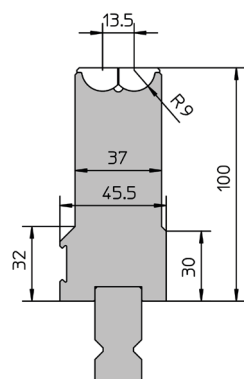

17,7mm (s=3mm)

RB 300 + EV W12/84°; Lengths
25, 30, 35, 40 und 45 available
upon request.

>A< RB 300

Die width: 12 mm

Angle: -

Height: 100 mm

Mat. No. Price

Single

100 1835708 - EUR

50 1835707 - EUR

Lengths in [mm]



RollBend

Delivery time: on request



1500 kN/m



42 Cr Mo 4
1080 - 1180 N/mm²



36,6 kg/m



~60 HRC



13,2 mm



22,7mm (s=4mm)



RB 400 + EV W16/84°; Lengths
25, 30, 35, 40 und 45 available
upon request.

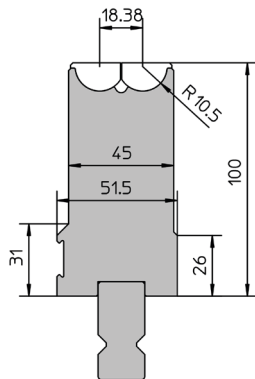

>A< RB 400

Die width: 16 mm

Angle: -

Height: 100 mm

Mat. No. Price

Single

100 1905749 - EUR

50 1905748 - EUR

Lengths in [mm]

Z bending

Punch

Delivery time: 2 weeks



1800 kN/m

42 Cr Mo 4
1080 - 1180 N/mm²

25,5 kg/m



~60 HRC



10 mm - 100 mm

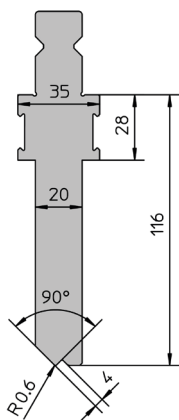

>A< OWZ/S 90°		Jogging:	Z4
		Angle:	90°
		Height:	116 mm
		Mat. No.	Price
Var. A			
1050	1906781		- EUR
550	1906750		- EUR
Block 250			
250	1906795		- EUR
Single			
100	1906788		- EUR
50	1906787		- EUR
45	1906786		- EUR
40	1906785		- EUR
35	1906784		- EUR
30	1906783		- EUR
25	1906782		- EUR

Lengths in [mm]

Die

Delivery time: 2 weeks



1800 kN/m

42 Cr Mo 4
1080 - 1180 N/mm²

23,0 kg/m



~60 HRC



10 mm - 100 mm

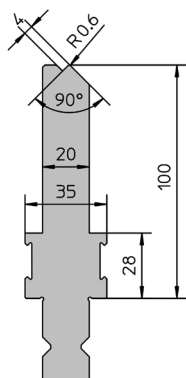

>A< EVZ 90°		Jogging:	Z4
		Angle:	90°
		Height:	100 mm
		Mat. No.	Price
Var. A			
1050	1906887		- EUR
550	1906886		- EUR
Block 250			
250	1906898		- EUR
Single			
100	1906897		- EUR
50	1906896		- EUR
45	1906895		- EUR
40	1906894		- EUR
35	1906893		- EUR
30	1906892		- EUR
25	1906891		- EUR

Lengths in [mm]



Punch

-  1800 kN/m
-  42 Cr Mo 4
1080 - 1180 N/mm²
-  25,7 kg/m
-  ~60 HRC
-  10 mm - 100 mm

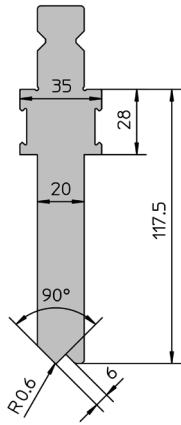





Delivery time: 2 weeks

>A< OWZ/S 90°		Joggling:	Z6
		Angle:	90°
		Height:	117,5 mm
		Mat. No.	Price
Var. A			
1050	1830741		- EUR
550	1830710		- EUR
Block 250			
250	1830752		- EUR
Single			
100	1830748		- EUR
50	1830747		- EUR
45	1830746		- EUR
40	1830745		- EUR
35	1830744		- EUR
30	1830743		- EUR
25	1830742		- EUR

Lengths in [mm]

Die

-  1800 kN/m
-  42 Cr Mo 4
1080 - 1180 N/mm²
-  23,0 kg/m
-  ~60 HRC
-  10 mm - 100 mm

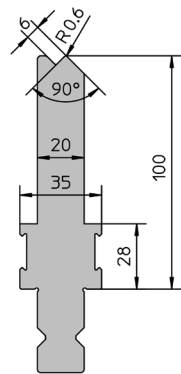

Delivery time: 2 weeks





>A< EVZ 90°		Joggling:	Z6
		Angle:	90°
		Height:	100 mm
		Mat. No.	Price
Var. A			
1050	1830847		- EUR
550	1830846		- EUR
Block 250			
250	1830858		- EUR
Single			
100	1830857		- EUR
50	1830856		- EUR
45	1830855		- EUR
40	1830854		- EUR
35	1830853		- EUR
30	1830852		- EUR
25	1830851		- EUR

Lengths in [mm]



Punch

Delivery time: 2 weeks

-  1800 kN/m
-  42 Cr Mo 4
1080 - 1180 N/mm²
-  29,4 kg/m
-  ~60 HRC
-  10 mm - 100 mm

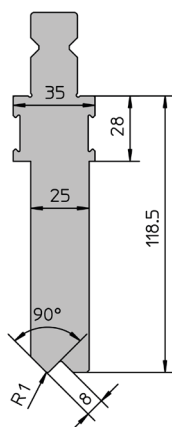





Delivery time: 2 weeks		
>A< OWZ/S 90°	Joggling:	Z8
	Angle:	90°
	Height:	118,5 mm
	Mat. No.	Price
Var. A		
1050	1906945	- EUR
550	1906944	- EUR
Block 250		
250	1906966	- EUR
Single		
100	1906962	- EUR
50	1906961	- EUR
45	1906950	- EUR
40	1906949	- EUR
35	1906948	- EUR
30	1906947	- EUR
25	1906946	- EUR

Lengths in [mm]

Die

Delivery time: 2 weeks

-  1800 kN/m
-  42 Cr Mo 4
1080 - 1180 N/mm²
-  25,8 kg/m
-  ~60 HRC
-  10 mm - 100 mm

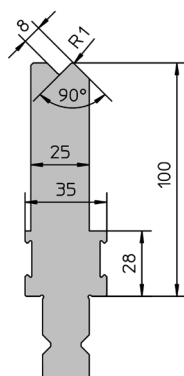

Delivery time: 2 weeks		
>A< EVZ 90°	Joggling:	Z8
	Angle:	90°
	Height:	100 mm
	Mat. No.	Price
Var. A		
1050	1906981	- EUR
550	1906970	- EUR
Block 250		
250	1906992	- EUR
Single		
100	1906991	- EUR
50	1906990	- EUR
45	1906989	- EUR
40	1906988	- EUR
35	1906987	- EUR
30	1906986	- EUR
25	1906985	- EUR

Lengths in [mm]



Punch



1800 kN/m



42 Cr Mo 4
1080 - 1180 N/mm²



29,6 kg/m



~60 HRC



10 mm - 100 mm

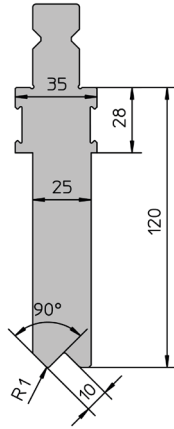

Delivery time: 2 weeks

>A< OWZ/S 90°		Joggling:	Z10
		Angle:	90°
		Height:	120 mm
		Mat. No.	Price
Var. A			
1050	1906997		- EUR
550	1906996		- EUR
Block 250			
250	1907038		- EUR
Single			
100	1907034		- EUR
50	1907033		- EUR
45	1907032		- EUR
40	1907031		- EUR
35	1907000		- EUR
30	1906999		- EUR
25	1906998		- EUR

Lengths in [mm]

Die



1800 kN/m



42 Cr Mo 4
1080 - 1180 N/mm²



25,7 kg/m



~60 HRC



10 mm - 100 mm

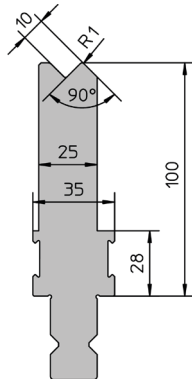

Delivery time: 2 weeks

>A< EVZ 90°		Joggling:	Z10
		Angle:	90°
		Height:	100 mm
		Mat. No.	Price
Var. A			
1050	1907062		- EUR
550	1907061		- EUR
Block 250			
250	1907073		- EUR
Single			
100	1907072		- EUR
50	1907071		- EUR
45	1907070		- EUR
40	1907069		- EUR
35	1907068		- EUR
30	1907067		- EUR
25	1907066		- EUR

Lengths in [mm]

Adapter



>A< Adapter

Delivery time: ex warehouse



2500 kN/m



42 Cr Mo 4
1080 - 1180 N/mm²



3,6 kg/m

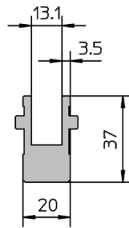

>A< TRUMPF - EV 13

Angle: -
Height: 37 mm
Mat. No. Price

Single

510 1771958 - EUR

Lengths in [mm]

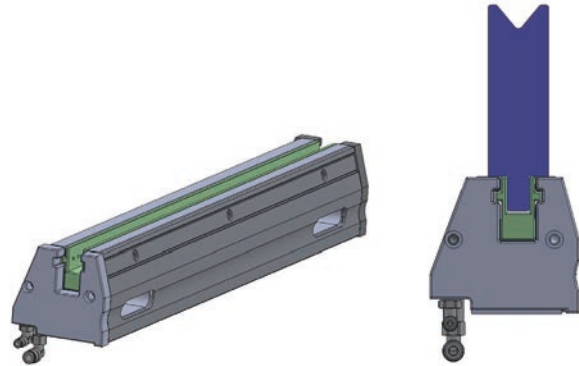



Upper tools

Designation	Illustration	Mat. No.	Price
>A< Safety-Click for OW200/S; OW280/S		1774517	- EUR
>A< Safety-Click for OW201/S; OW204/S		1774480	- EUR
>A< Safety-Click for OW202/S; OW203/S; OW211/S; OW215/S; OW282/S; OWZ/S Z4...Z10;		1774479	- EUR



Lower tools

Designation	Illustration	Mat. No.	Price
>A< Safety-Click for EV W30/80°		1774511	- EUR
>A< Safety-Click for EV W30/30°; EV W40/80°		1774513	- EUR
>A< Safety-Click for EV EV W40/30°		1774514	- EUR
>A< Safety-Click for EV W50/80°		1774515	- EUR
>A< Safety-Click for EV W6 ...W24; EV/S W4 ...W12; EV-F W6,2; EVZ Z4...Z10		1774479	- EUR
>A< Safety-Click for EV W24/30°		1774480	- EUR



ACB Sensor tools

Designation	Illustration	Mat. No.	Price
>A< additional license for software		2298019	- EUR
electronic screwdriver 2,5x50		0140800	- EUR
Torque Screwdriver complete		2234347	- EUR
Reversing blade slotted 0,5x3 for Torque Screwdriver		1940273	- EUR
stop pin		0902665	- EUR
assembly sheet		0906262	- EUR

Designation	Illustration	Mat. No.	Price
Spacer 0.1x12.7		0903268	- EUR
>A< calibrating die 90° complete		2285833	- EUR



ACB initial equipment TruBend Cell 7000

Note:

An initial equipment is a requirement for the first machine! A supplementary license is required for each additional machine.

Technical data	ACB Wireless >A<
Sensor tools	All usual >A< standard punches. Special radiuses upon request.
Tool width	25 mm
Max. number of sensors for each bending/Max. number of sensors	2 / 8
Prerequisite	
Machine	TruBend Cell 7000 (B06) mit ACB Vorbereitung Serienstand 9.00

Scope of delivery ACB Wireless >A<

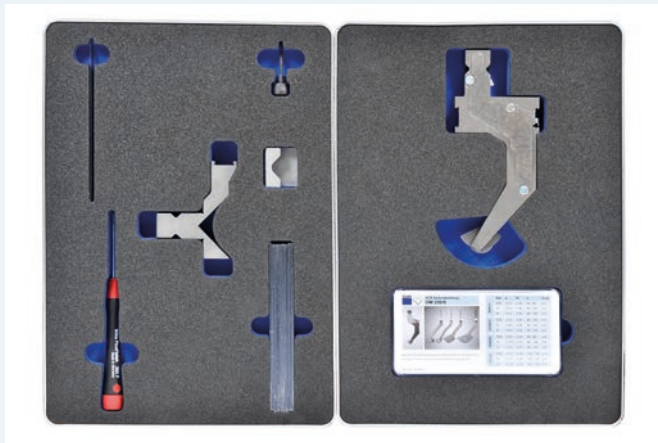

Initial equipment consisting of:

- 1 ACB Wireless sensor tool >A< (specified by the customer)
- 1 ACB software (form with Code No.)

Accessories:

- 1 Locking pin
- 1 90° calibrating die
- 1 Electronic screwdriver 2.5
- 1 Spacer
- 1 Assembly sheet
- 10 Test sheets

System division of >A< bending tools

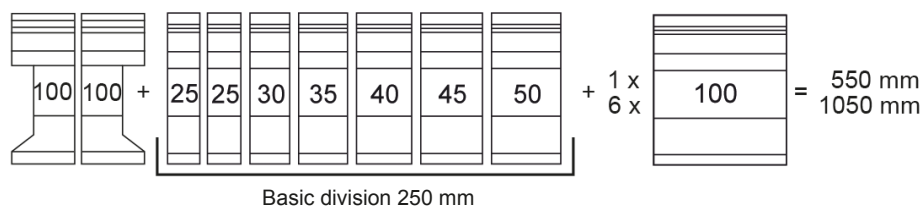

- For lower tools, division is as for upper tools.
- Horn tools are replaced with 100 mm parts.

Base tools

- The minimum shaft length for an >A< tool is 25 mm
- >A< base tools are modified from 25 mm standard parts.

available in the catalog

>A< OW/EV center

L = 10/15/20 mm

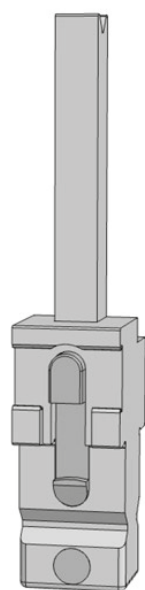

L = 25 mm

available on request

>A< OW left



>A< OW right

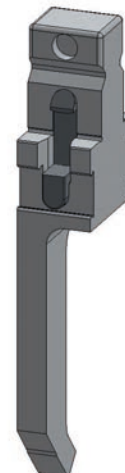

>A< EV left

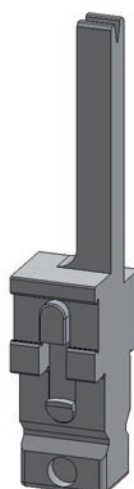

>A< EV right

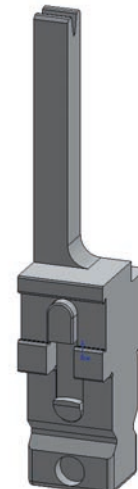

Upper tools

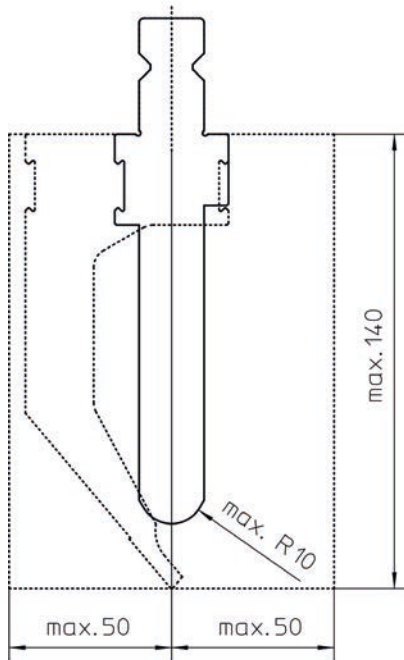

- Maximum tool height: 140 mm
- Maximum width: 50 mm (bending line clearance - maximum outer contour)
- Special radii from 10 mm on request
- Maximum weight: 6 kg
- Max. tool part length 100 mm (special lengths on request)

Lower tools

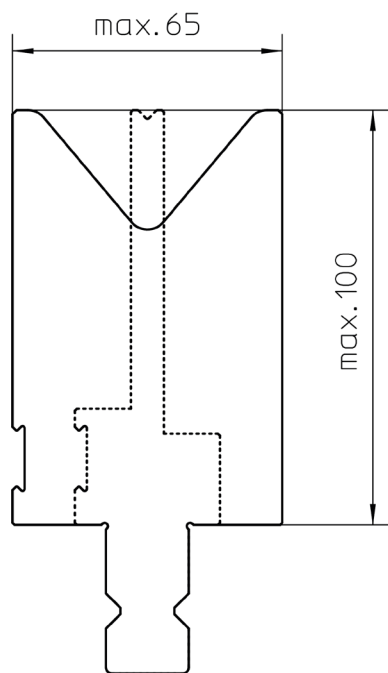

- Standard tool height: 100 mm
- Minimum die width: 4 mm → Breite 8 mm
- Maximum die width: 50 mm → Breite 65 mm
- Minimum possible lower tool design: width = 8 mm
- Maximum lower tool width: EV W50/80° : 65 mm
- Minimum shoulder width = 35 mm (20 mm + 2 x 7,5 mm)
- Maximum weight: 6 kg
- Max. tool part length 100 mm (special lengths on request)

Special tools

- On request
- Determination of tracking curves is partly required

Tool variants

Upper tool holder



In the upper tool holder, manual standard upper tools can be used, but there is an increased risk of damage (since there are no roundings on the upper tool).

TRUMPF does **not** guarantee the use of 'manual' standard tools. There is only a guarantee for the use of >A< upper tools.

Lower tool holder

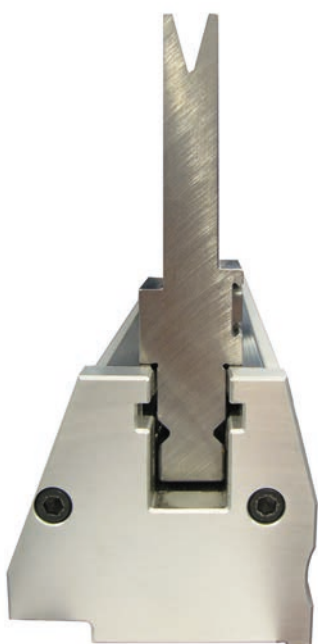

In the lower tool holder, only >A< tools may be used. In the event that a manual standard die is used with a 13 mm receiver, the >A> adapter must be used.



Addresses

TRUMPF Werkzeugmaschinen Deutschland, Vertrieb + Service GmbH + Co KG

Deutschland Johann-Maus-Straße 2
D-71254, Ditzingen

☎ +49 7156 303 33222
✉ +49 7156 303-31473
🌐 www.trumpf.com
@ biegewerkzeuge@de.trumpf.com

TRUMPF Maschinen Austria GmbH & Co KG

Österreich Industriepark 24
A-4061 Pasching

☎ +43 7221 603 0
✉ +43 7221 603 42037
🌐 www.trumpf.com
@ biegewerkzeuge@at.trumpf.com

TRUMPF S.A.S.

France Paris Nord II, 86 Allée des Erables
F-95956 Roissy-Charles-de-Gaulle

☎ +33-1-48 17 8042
✉ +33-1-48 630 579
🌐 www.trumpf.com
@ outillages@fr.trumpf.com

TRUMPF Maschinen AG

Schweiz Ruessenstr. 8
CH-6341 Baar

☎ +41 (58) 257 76 72
✉ +41 (58) 257 64 01
🌐 www.trumpf.com
@ ch-werkzeug@ch.trumpf.com

TRUMPF S.r.l.

Italia Via del Commercio
I-20090 Buccinasco (MILANO)

☎ +39-02 4848 9 420
✉ +39-02 4848 9 501
🌐 www.trumpf.com
@ utensili@it.trumpf.com

TRUMPF Maquinaria S.A.

España C/ Valportillo Primera nº 1
E-28108 Alcobendas (Madrid)

☎ +34 916 573 669
✉ +34-916 614 213
🌐 www.trumpf.com
@ miguel.pascual@es.trumpf.com

TRUMPF Maskin AB

Sverige Aleforsvägen 5
S-44117 Alingsås

☎ +46-322-669700
✉ +46-322-669710
🌐 www.trumpf.com
@ order@se.trumpf.com

TRUMPF Slovakia s.r.o.

Slovensko Galgovecká 7
SK - 040 11 Kosice

☎ +421-55-728 09 17
✉
🌐 www.trumpf.com
@ nastroje@sk.trumpf.com

TRUMPF Praha spol. s r.o.

Ceská Republika K Hájum 2a
CZ-155 00 PRAHA 5 - Stodulky

☎ +420/251 106 214 (/ 215 / 219)
✉ +420/251 106 201
🌐 www.trumpf.com
@ info@cz.trumpf.com

TRUMPF Polska Spółka z ograniczona odpowiedzialności Sp.k.

Polska ul. Krzywowa 8
61-545 Poznań

☎ +48 225753933
✉ +48 225753901
🌐 www.trumpf.com
@ info@trumpf.pl

TRUMPF Corporation

Japan 1-18-2 Hakusan, Midori-ku
JPN-Yokohama 2260006

☎ +81-45-931-57 10
✉ +81-45-931-57 14
🌐 www.trumpf.com
@ tools@trumpf.co.jp

TRUMPF Pte Ltd

Singapore 25 International Business Park,#02-
28/29 German Center
Singapore 609916

☎ +65-65 62 77 80
✉ +65-65 62 77 88
🌐 www.trumpf.com
@ bendmt@trumpf.com.sg

TRUMPF Hungary Kft.

Magyarország Lincoln u. 1 I. em.
2220, Vecsés

☎ +36 29 999 100
✉ +36 29 999 101
🌐 www.trumpf.com
@ szerszam@hu.trumpf.com

V.A.C. Machines nv/sa

België Kleine Pathoekeweg 13-15
B-8000 Brugge

☎ +32-50-31 50 83
✉ +32-504 56058
🌐 www.vac-machines.be
@ spare.parts@vac-machines.be

Oy Tammesvirta & Co

Suomi Vanha Porvoontie 229
FIN-01380 VANTAA

☎ +358-9-77407 40
✉ +358-9-774074 11
🌐 www.tammesvirta-co.fi
@ sten.tammesvirta@tammesvirta-co.fi

AVN PLADETEKNIK A/S

Danmark Dalager 1
DK-2605, Brøndby

☎ +45-7020-0411
✉ +45-4324-5537
🌐 www.avn.dk
@ bre@avn.dk

TRUMPF Nederland B.V.

Nederland John Maynard Keynesstraat 301
NL-7559 SV Hengelo

☎ +31 88 4002-440
✉ +31 88 4002-444
🌐 www.trumpf.com
@ onderdelen@nl.trumpf.com

TRUMPF Inc.

United States 111 Hyde Road, Farmington
CT 06032, USA

☎ +1 860 255 6000
✉ +1 860 255 6433
🌐 www.trumpf.com
@ pressbraketooling@us.trumpf.com

TRUMPF Ltd.

United Kingdom President Way, Airport Executive Park
GB-Luton Beds. LU2 9NL

☎ +44-158 2399 221
✉ +44-158 2399 261
🌐 www.trumpf.com
@ tooling@uk.trumpf.com